

**BUFFALO COUNTY BOARD OF COMMISSIONERS
BUFFALO COUNTY BOARD OF EQUALIZATION
TUESDAY, JUNE 11, 2024**

The Buffalo County Board of Commissioners and the Buffalo County Board of Equalization met on Tuesday, June 11, 2024 at 9:00 A.M. and 9:30 A.M. Chairperson Klein called the meeting to order and led those present in the Pledge of Allegiance. The following Board members responded to roll call: Timothy Higgins, Myron Kouba, Ronald Loeffelholz, Daniel Lynch, Bill Maendele, Sherry Morrow and Ivan Klein. A copy of the acknowledgment and receipt of notice and agenda by the Board of Commissioners is attached to these minutes. Public notice of this meeting was published/posted in the Kearney Hub, on the Buffalo County website, and the bulletin boards located outside the County Clerk’s office and County Board Room on June 6, 2024. Chairperson Klein announced that in accordance with Section 84-1412 of the Nebraska Revised Statutes, a current copy of the Open Meetings Act is available for review and posted at the back of the Board Room. County Clerk Heather Christensen took all proceedings hereinafter shown; while the convened meeting was open to the public. Deputy County Attorney Andrew Hoffmeister and Deputy County Attorney Josiah Davis were present.

REGULAR AGENDA

Moved by Higgins and seconded by Loeffelholz to approve the May 28, 2024 Board meeting minutes. Upon roll call vote, the following Board members voted "Aye": Higgins, Loeffelholz, Kouba, Lynch, Maendele, Morrow and Klein. Motion declared carried.

Moved by Morrow and seconded by Higgins to ratify the following May 31, 2024 payroll claims processed by the County Clerk. Upon roll call vote, the following Board members voted "Aye": Morrow, Higgins, Kouba, Loeffelholz, Lynch, Maendele and Klein. Motion declared carried.

MAY 31, 2024 PAYROLL

<u>GENERAL FUND</u>			
NET PAYROLL			359,394.78
RETIREMENT PLANS AMERITAS	R	EMPE RET	59,028.43
FIRST NATIONAL BANK	T	FEDERAL TAXES	119,960.59
ERIN M MCCARTNEY	E	GARNISHMENT	402.00
STATE OF NE	T	STATE TAXES	20,142.08
<u>ROAD FUND</u>			
NET PAYROLL			72,326.78
RETIREMENT PLANS AMERITAS	R	EMPE RET	10,267.94
FIRST NATIONAL BANK	T	FEDERAL TAXES	21,167.52
STATE OF NE	T	STATE TAXES	3,288.18
<u>WEED FUND</u>			
NET PAYROLL			5,841.46
RETIREMENT PLANS AMERITAS	R	EMPE RET	870.45
FIRST NATIONAL BANK	T	FEDERAL TAXES	1,847.73
STATE OF NE	T	STATE TAXES	291.86

Moved by Higgins and seconded by Loeffelholz to approve the early claim submitted by the County Clerk as listed below. Upon roll call vote, the following Board members voted "Aye": Higgins, Loeffelholz, Kouba, Lynch, Maendele, Morrow and Klein. Motion declared carried.

<u>BUILDING & GROUND FUND</u>			
SOLID WASTE LANDFILL USE	E	DEMO	214.37

Moved by Maendele and seconded by Morrow to ratify the following May 2024 election worker payroll claims submitted by the County Clerk. Upon roll call vote, the following Board members voted "Aye": Maendele, Morrow, Higgins, Kouba, Loeffelholz, Lynch and Klein. Motion declared carried.

<u>GENERAL FUNDS</u>			
DEBRA G ABELS	E	ELECTION	212
JIMMI ANN ANDERSON	E	ELECTION	66.5
GINGER R AXTELL	E	ELECTION	208.75
JODENE L BALDWIN	E	ELECTION	343
CARLOS E BARRON	E	ELECTION	234.75
KELLY H BARTLING	E	ELECTION	221.38
REX A BAUER	E	ELECTION	212
EMILY M BEAMAN	E	ELECTION	205.5
WILLIAM H BEBB	E	ELECTION	226

EUGENE F BEERBOHM	E	ELECTION	95
JANET S BEERBOHM	E	ELECTION	208.75
HEATHER BENTLEY	E	ELECTION	202.25
FREDERICK J BLUME	E	ELECTION	208.75
KAREN J BOHAC	E	ELECTION	222.5
KATHERINE SCOTT BOKENKAMP	E	ELECTION	163.25
PATRICIA L BOWIE	E	ELECTION	212
JAN L BRANDT	E	ELECTION	222.5
VIRGINIA A BRITTON	E	ELECTION	219
LINDA C BRODINE	E	ELECTION	292.56
JULIA A BROOKER	E	ELECTION	229.5
AMBER S BROWN	E	ELECTION	202.25
SANDRA BROZ	E	ELECTION	208.75
MARY K BRYSON	E	ELECTION	212
KRISTY L BUCHMEIER	E	ELECTION	219
PATRICK B BUDLER	E	ELECTION	205.5
JEFFREY BULLOCK	E	ELECTION	52.5
DEBORAH JO BUNGER	E	ELECTION	205.5
JUDY A BURMOOD	E	ELECTION	205.5
ROBERT D BYRN	E	ELECTION	240.74
HEATHER M CHACON	E	ELECTION	205.5
GARY D CLARK	E	ELECTION	202.25
LORI L CODY	E	ELECTION	205.5
LINDA COVEY	E	ELECTION	205.5
LUCAS ELLIOT CRITTENDEN	E	ELECTION	52.5
ARDITH R DAVENPORT	E	ELECTION	205.5
CONNIE DE JONGE	E	ELECTION	229.5
LUCINDA A DENNIS	E	ELECTION	30
KELLY S DEWEESE	E	ELECTION	233.22
JAMES L DUBAS	E	ELECTION	208.75
JEAN M EICHHORST	E	ELECTION	212
BRETTE ASHLEY ENSZ	E	ELECTION	30
HEIDE M EPLEY	E	ELECTION	212
AARON G ESTES	E	ELECTION	185.25
GARY R FEIND	E	ELECTION	219
SUSAN FELDNER	E	ELECTION	153.5
KATHLEEN M FISHER	E	ELECTION	222.5
KATHRYN J FITZGERALD	E	ELECTION	222.5
ROBERT F FITZGERALD	E	ELECTION	226
JAMES L FRUHLING	E	ELECTION	208.75
KAREN R GARRELTS	E	ELECTION	232.1
ELLEN L GEIST	E	ELECTION	218.5
MARY L GEORGE	E	ELECTION	215.5
VICKI LEA GIBBONS	E	ELECTION	205.5
MELVIN DALE GIBBS	E	ELECTION	219
JERRY W GLOYSTEIN	E	ELECTION	208.75
ROSALIE J GOLDBERG	E	ELECTION	215.25
LANA L GOSCH	E	ELECTION	202.25
JUDITH A GOSS	E	ELECTION	212
JAN M GUNDERSON	E	ELECTION	205.5
BYRON D HANSEN	E	ELECTION	208.75
LARRY HARDESTY	E	ELECTION	221.65
COLEEN M HARMONEY	E	ELECTION	202.25
LINDA HARR	E	ELECTION	202.25
MICHELLE R HAYES	E	ELECTION	208.75
CAROL M HERRON	E	ELECTION	205.5
CATHERINE R HERVERT	E	ELECTION	235.65
DANIELLE MARIE HILTON	E	ELECTION	80.5
M KATHLEEN HOFFMAN	E	ELECTION	205.5
SHARON K HOFFMAN	E	ELECTION	121
TERESA A HONGSERMEIER	E	ELECTION	212
SUSAN E JASNOCH	E	ELECTION	222.5
CHELSEA LYNNE JENSEN	E	ELECTION	202.25
PAMELA J JOHN	E	ELECTION	299.7

ROBERT L JOHNSON	E	ELECTION	202.25
DIANA L JONES	E	ELECTION	205.5
DARLA J JUHL	E	ELECTION	208.75
MARILEE K KABES	E	ELECTION	56.28
SUSAN K KEIZER	E	ELECTION	208.75
JUNE L KENTON	E	ELECTION	205.5
LARRY L KENTON	E	ELECTION	226
MYRA E KING	E	ELECTION	202.25
CORTNEY C KLEIN	E	ELECTION	226
LEANN KLEIN	E	ELECTION	259.2
JEAN L KOLBO	E	ELECTION	226
CAROL L KRUEGER	E	ELECTION	227.78
KEITH A KUCERA	E	ELECTION	210.32
HEIDI L LA CLAIR	E	ELECTION	212
LEANNE M LACEY	E	ELECTION	205.5
SHERRY J LANE	E	ELECTION	202.25
LINDA T LIEBIG	E	ELECTION	208.75
BARBARA J LINDNER	E	ELECTION	285.24
NANCY L LOWE	E	ELECTION	205.5
MAUREEN J LUCHT	E	ELECTION	205.5
VONDA K LUNDELL	E	ELECTION	219
VICTORIA L LUTH	E	ELECTION	202.25
FRANCES L MADSEN	E	ELECTION	202.25
DEANNA D MALZACHER	E	ELECTION	30
MARTHA MARIA MARFILENO	E	ELECTION	205.5
BRENDA K MARSHALL	E	ELECTION	168
SHARON L MARTIN	E	ELECTION	220.24
MISHELLE R MAUL	E	ELECTION	221.38
JEANNE M MAY	E	ELECTION	247.59
ANN T MCGOWAN	E	ELECTION	202.25
KYLA A MCGREGOR	E	ELECTION	250.24
ADARENE M MIIGERL	E	ELECTION	202.25
KENDI LYNN MIIGERL	E	ELECTION	202.25
JUDY I MILLER	E	ELECTION	215.45
LINDA A. MILLER	E	ELECTION	202.25
JEAN M MOORE	E	ELECTION	271.56
LARRY D MUEGGENBERG	E	ELECTION	202.25
LISA M NEAL	E	ELECTION	202.25
LINDA M NEEMEYER	E	ELECTION	215.95
LISA M NEUHEISEL	E	ELECTION	212
DEBRA S NICHOLS	E	ELECTION	229.5
KAREN L NIELSEN	E	ELECTION	208.75
LAUREN M O'BRIEN	E	ELECTION	202.25
CARLA L OGORZOLKA	E	ELECTION	226.52
KATHRYN A OLSUFKA	E	ELECTION	208.75
MARSHA DIANE OURADA	E	ELECTION	205.5
JOANNE M PAITZ	E	ELECTION	292.33
ANN MARIE PARK	E	ELECTION	202.25
JANETTE PAXSON	E	ELECTION	218.5
THOMAS R PAXSON	E	ELECTION	218.5
RODGER ALLEN PAYNE	E	ELECTION	208.75
DEBORAH SUE PENNY	E	ELECTION	226
KIRBY D PENNY	E	ELECTION	224.9
ROBERT E PETERSON	E	ELECTION	208.75
KAYDEN POFF	E	ELECTION	52.5
DEBORA L QUINN	E	ELECTION	205.5
CLAY RASMUSSEN	E	ELECTION	52.5
THOMAS K RAYBURN	E	ELECTION	212
ROCHELLE A REEVES	E	ELECTION	202.25
KIMBRA L ROBERTS	E	ELECTION	226
ANTOINETTE HALLET ROSENBERG	E	ELECTION	212
JOHN M ROSS	E	ELECTION	30
CYNTHIA A RYAN	E	ELECTION	212
PAUL O SAALFELD	E	ELECTION	205.5

KATHRYN R SAYER	E	ELECTION	205.5
JANENE K SCHAKE	E	ELECTION	262.7
PAUL A SCHINKEL	E	ELECTION	219.91
RONALD J SCHNEIDER	E	ELECTION	202.25
DAWN R SCHOETTGER	E	ELECTION	208.75
ANDREA T SCHROEDER	E	ELECTION	279.6
BRENDA K SCHROEDER	E	ELECTION	205.5
CATHY JEAN SCHROEDER	E	ELECTION	208.75
BEVERLY L SCHUMACHER	E	ELECTION	69
SHEILA L SCOTT	E	ELECTION	205.5
ROBERT M SCRIVEN	E	ELECTION	30
JOYCE A SEARS	E	ELECTION	202.25
PAUL E SEARS	E	ELECTION	30
DIANA J SHUBERT	E	ELECTION	205.5
JUDITH M SICKLER	E	ELECTION	208.75
BARBARA J SIEDENBURG	E	ELECTION	218.36
VANCE V SIEDENBURG	E	ELECTION	205.5
CYNTHIA L SMIDT	E	ELECTION	205.5
LOIS C SMITH	E	ELECTION	205.5
MARY S SOMMERS	E	ELECTION	205.5
LESLIE SPACE	E	ELECTION	63
JEANNIE STADE	E	ELECTION	202.25
EVELYN K STITTLE	E	ELECTION	202.25
CARTER SYMINGTON	E	ELECTION	52.5
JANICE TAUBENHEIM	E	ELECTION	202.25
BARBARA THOMPSON	E	ELECTION	205.5
KAY I THOMPSON	E	ELECTION	205.5
REBECCA S THORNTON	E	ELECTION	208.75
SANDRA ANN TRYKOWSKI NICKLASSON	E	ELECTION	205.5
JOHN E TUREK	E	ELECTION	215.5
BARBARA A TUTTLE	E	ELECTION	208.75
THOMAS W TYE II	E	ELECTION	205.5
LINDA K VAN ORSDALL	E	ELECTION	205.5
REBECCA S WALLINE	E	ELECTION	111.25
ASHLEY MARIE WEETS	E	ELECTION	30
CHARMEEN A WHITE	E	ELECTION	213.54
CAROL J WHITESEL	E	ELECTION	202.25
OLIVIA ANNE WHITTAKER	E	ELECTION	205.5
KARLA M WILD	E	ELECTION	36.18
JANET S WILKE	E	ELECTION	205.5
PAMELA J WITTE	E	ELECTION	504.37
HOWARD WONG	E	ELECTION	208.75
BRIDGET J WORM	E	ELECTION	226
ANNETTE WOZNAK	E	ELECTION	230.66
WILLIAM J WOZNAK	E	ELECTION	208.75
AARON K WRIGHT	E	ELECTION	212
SCOTT E WROBEL	E	ELECTION	215.25
MARILYN S ZIMMER	E	ELECTION	202.25
CLAYTON ZIMNIAK	E	ELECTION	300
ROBERT D ZUEHLSDORF	E	ELECTION	240.71

Moved by Morrow and seconded by Lynch to accept the Buffalo County Treasurer May 2024 Fund Balance Report. Upon roll call vote, the following Board members voted "Aye": Morrow, Lynch, Higgins, Kouba, Loeffelholz, Maendele and Klein. Motion declared carried.

Moved by Higgins and seconded by Loeffelholz to approve the following Resolution 2024-24 authorizing County Attorney Shawn Eatherton to proceed with the foreclosure of County owned Tax Sale Certificates. Upon roll call vote, the following Board members voted "Aye": Higgins, Loeffelholz, Kouba, Lynch, Maendele, Morrow and Klein. Motion declared carried.

RESOLUTION 2024-24

WHEREAS, The Revised Statutes of Nebraska, 77-1901 through 77-1918 provides upon resolution by the County Board of Commissioners for foreclosure and sale of Real Estate Properties upon which Tax Sale Certificates have been placed and delinquent for three years, and

WHEREAS, the following Tax Sale Certificates have been placed on Real Estate Properties in Buffalo County, to wit:
Numbers: 21250

NOW THEREFORE BE IT RESOLVED, that the Buffalo County Board of Commissioners authorize the foreclosure and sale of the above referenced Tax Sale Certificates and request the County Attorney to proceed to such foreclosure and sale, in accordance with the laws of the State of Nebraska.

Moved by Higgins and seconded by Kouba to approve the following tax refund request submitted by County Treasurer Brenda Rohrich for KAPPA Ethanol Ravenna LLC in the amount of \$4,839.35 for parcel number 325001105. Upon roll call vote, the following Board members voted "Aye": Higgins, Kouba, Loeffelholz, Lynch, Maendele, Morrow and Klein. Motion declared carried.

Moved by Morrow and seconded by Loeffelholz to approve the addition of pledged collateral in the amount of \$41,766.00 for the Buffalo County Treasurer at Firstier Bank. Upon roll call vote, the following Board members voted "Aye": Morrow, Loeffelholz, Higgins, Kouba, Lynch, Maendele and Klein. Motion declared carried.

Moved by Morrow and seconded by Maendele to accept the Clerk of the District Court May 2024 Report. Upon roll call vote, the following Board members voted "Aye": Morrow, Maendele, Higgins, Kouba, Loeffelholz, Lynch and Klein. Motion declared carried.

Moved by Morrow and seconded by Kouba to ratify Chairperson Klein's signature on a letter of support for the City of Kearney. Upon roll call vote, the following Board members voted "Aye": Morrow, Kouba, Higgins, Loeffelholz, Lynch, Maendele and Klein. Motion declared carried.

Lieutenant Robert Tubbs was present to request dismissal of previous bid decision for the Radio Project Jail Portables of May 28, 2024. No one else addressed the Board. Moved by Maendele and seconded by Kouba to dismiss the Radio Project Jail Portables bids awarded on May 28, 2024. Upon roll call vote, the following Board members voted "Aye": Maendele, Kouba, Higgins, Loeffelholz, Lynch, Morrow and Klein. Motion declared carried.

After discussion and review of the County Sheriff's report, it was moved by Lynch and seconded by Loeffelholz to approve the Special Designated Liquor License application filed by B&B Research and Investments LLC; Trade Name: Village 1919, DBA: The Village for an event to be held at "The Farm" located at 51460 100th Road Shelton, NE 68876 on June 29, 2024. Upon roll call vote, the following Board members voted "Aye": Lynch, Loeffelholz, Higgins, Kouba, Maendele, Morrow and Klein. Motion declared carried.

Moved by Higgins and seconded by Lynch to approve the following Change Order Requests for the Condition and Needs Assessment Wilkins Architecture; Request #1 in the amount of \$20,074.88 for travel expenses and is on file with the County Clerk. Upon roll call vote, the following Board members voted "Aye": Higgins, Lynch, Kouba, Loeffelholz, Maendele, Morrow and Klein. Motion declared carried.

Moved by Higgins and seconded by Lynch to approve flu shots for all Buffalo County Employees to be administered by Two Rivers Public Health. The Board Administrator will notify the employees of the flu shot availability. Upon roll call vote, the following Board members voted "Aye": Higgins, Lynch, Kouba, Loeffelholz, Maendele, Morrow and Klein. Motion declared carried.

Moved by Loeffelholz and seconded by Higgins to accept the Emergency Management 2023 Summary Report to be filed with the County Clerk. Upon roll call vote, the following Board members voted "Aye": Loeffelholz, Higgins, Kouba, Lynch, Maendele, Morrow and Klein. Motion declared carried.

ZONING

Deputy County Attorney Andrew Hoffmeister and Zoning Administrator Dennise Daniels were present for the following Zoning agenda items.

Chairperson Klein opened the public hearing at 9:21 A.M. for an Administrative Subdivision filed by Mitchell Humphrey, licensed land surveyor, on behalf of Marilyn Trampe, who holds a life estate, Charlene L. Pratt, David C. Trampe, Daniel D. Trampe, Derry L. Trampe, Karen S. Hemmann, Dean J. Trampe, Darrin D. Trampe, Marla V. Trampe, Heath A. Trampe, and Matthew D. Trampe, to be known as "D Trampe Administrative Subdivision." This property is located in Part of the Northeast Quarter of the Southeast Quarter of Section Twenty-Three (23), Township Eleven (11) North, Range Seventeen (17) West of the Sixth Principal Meridian, Buffalo County, Nebraska. Licensed land surveyor Humphrey was present to review the application and answer questions. No one else addressed the Board and Chairperson Klein closed the hearing at 9:23 A.M. Moved by Loeffelholz and seconded by Lynch to

approve the Administrative Subdivision to be known as "D Trampe Administrative Subdivision" with the following Resolution 2024-25. Upon roll call vote, the following Board members voted "Aye": Loeffelholz, Lynch, Higgins, Kouba, Maendele, Morrow and Klein. Motion declared carried.

RESOLUTION 2024-25

WHEREAS, Mitchell Humphrey, licensed land surveyor, on behalf Marilyn Trampe, who holds a life estate, Charlene L. Pratt, David C. Trampe, Daniel D. Trampe, Derry L. Trampe, Karen S. Hemmann, Dean J. Trampe, Darrin D. Trampe, Marla V. Trampe, Heath A. Trampe, Matthew D. Trampe, hereinafter referred to as "applicants", has filed for an Administrative Subdivision to be known as "D Trampe Administrative Subdivision", with the Buffalo County Clerk and/or Zoning Administrator, and

WHEREAS, the Zoning Administrator forwarded this application to this Board, and

WHEREAS, on June 11, 2024, this Board conducted a public hearing now and finds:

1. The proposed "D Trampe Administrative Subdivision" is in the Agricultural (AG) Zoning District for Buffalo County, Nebraska.
2. The remaining portion of the subdivided tract, presently owned by Marilyn Trampe, who holds a life estate, Charlene L. Pratt, David C. Trampe, Daniel D. Trampe, Derry L. Trampe, Karen S. Hemmann, Dean J. Trampe, Darrin D. Trampe, Marla V. Trampe, Heath A. Trampe, Matthew D. Trampe, referred to as Parcel 220151400, and situated in the South Half and the West Half of the Northwest Quarter in Section Twenty-Three (23), Township Eleven (11) North, Range Seventeen (17) West of the Sixth Principal Meridian, Buffalo County, Nebraska, AND Parcel 220050100, situated in the East Half of the Northeast Quarter, Section Twenty-Two (22), Township Eleven (11) North, Range Seventeen (17) West of the Sixth Principal Meridian, Buffalo County, Nebraska, complies with the minimum lot size of this zoning district; any remnant property not subdivided and owned by Marilyn Trampe, who holds a life estate, Charlene L. Pratt, David C. Trampe, Daniel D. Trampe, Derry L. Trampe, Karen S. Hemmann, Dean J. Trampe, Darrin D. Trampe, Marla V. Trampe, Heath A. Trampe, Matthew D. Trampe, amounts to roughly 477 acres.
3. The proposed plat for this subdivision fulfills Buffalo County's Subdivision Resolution requirements for administrative subdivisions specifically allowed under Section 3.02, together with other provisions applicable, thereto.
4. Sartoria Road is a county-maintained, open public road and it abuts the subdivision on its east side. The width of Sartoria Road meets this county's minimum width standards.
5. Title search paperwork has been provided to the Buffalo County Attorney's Office and that office has cleared title as concerns Buffalo County's interests based upon the title search documents delivered to that office by applicant.
6. This proposed administrative subdivision should be approved.

NOW THEREFORE, BE IT RESOLVED BY THE BUFFALO COUNTY BOARD OF COMMISSIONERS in regular session with a quorum present, that the plat of "D Trampe Administrative Subdivision", an administrative subdivision being located in Part of the Northeast Quarter of the Southeast Quarter of Section Twenty-Three (23), Township Eleven (11) North, Range Seventeen (17) West of the Sixth Principal Meridian, Buffalo County, Nebraska, duly made out, acknowledged and certified, is hereby approved, accepted, ratified, and authorized to be filed and recorded in the Office of the Register of Deeds, Buffalo County, Nebraska.

REGULAR AGENDA

Aravind Menon, PhD, Epidemiologist was present to present the quarterly update from Two Rivers Public Health Department and a copy of the presentation is on file with the County Clerk.

Moved by Loeffelholz and seconded by Higgins to recess the regular meeting of the Board of Commissioners at 9:43 A.M. and reconvene as a Board of Equalization. Upon roll call vote, the following Board members voted "Aye": Loeffelholz, Higgins, Kouba, Lynch, Maendele, Morrow and Klein. Motion declared carried.

BOARD OF EQUALIZATION

Chairperson Klein called the Board of Equalization to order in open session. County Assessor Roy Meusch and Deputy County Treasurer Michele Richardson were present.

Moved by Lynch and seconded by Loeffelholz to approve the Motor Vehicle Tax Exemption renewal as indicated on the application by County Treasurer Rohrich for Community Action Partnership of Mid-Nebraska for a 1999 GMC Sierra Pickup, a 2004 Ford Freestar, a 2004 Carry On Utility, a 2007 Droyal Enclosed, a 2008 Chrysler Town & Country, a 2009 Chevy C3500(Sage), a 2009 Chevy Cobalt, a 2009 Chevy Colorado (Bill W), a 2009 Chevy K2500 (Wayland), a 2009 Chevy Colorado (Sage), a 2010 Hyundai Santa Fe, a 2010 Ford Transit Connect, a 2010 Dodge Caravan, two 2011 Dolittle Trailers, a 2011 Chevy Malibu- Blue EHS, a 2011 Hyundai Sonata, a 2011 Ford Ranger, a 2013 Mazda MX6, a 2014 Chevy Cruze LT, a 2014 Sharp Enclosed, a 2015 International, a 2015 Chevy Malibu, a 2017 International 4300, two 2017 Chevy Equinoxes, a 2018 Buick Encore, a 2018 Dodge Journey, a 2019 Dodge Caravan, a 2019 Kia Optima, a 2019 Ford Fusion, a 2020 Chrysler Voyager, a 2022 Jeep Cherokee, three 2022 Chevrolet Equinoxes, and a 2022 Ford Transit. Upon roll call vote, the following Board members voted "Aye": Lynch, Loeffelholz, Higgins, Maendele, Morrow and Klein. Abstain: Kouba. Motion declared carried.

Moved by Kouba and seconded by Higgins to approve the Motor Vehicle Tax Exemption renewal as indicated on the application by County Treasurer Brenda Rohrich for New Life Assembly for a 1981 GMC Suburban, a 1990 Homemade Pickup Box Trailer, a 1995 Ford Club Wagon, a 1996 Ford El Dorado Bus E350, a 2003 International 47 Passenger Bus, a 2005 Homemade Utility Trailer, a 2006 Royal Enclosed Trailer, a 2008 H&H Enclosed Trailer, a 2012 Ford 12 Passenger Shuttle, a 2014 Sharp Enclosed Trailer, a 2017 Ford

Transit Wagon T-35, a 2020 Dodge Extended P and a 2021 Ford Transit Wagon. Upon roll call vote, the following Board members voted "Aye": Kouba, Higgins, Loeffelholz, Lynch, Maendele, Morrow and Klein. Motion declared carried.

Chairperson Klein opened the Permissive Exemption hearing for International Church of the Foursquare Gospel at 9:46 A.M. No one addressed the Board. Chairperson Klein closed the Permissive Exemption hearing at 9:48 A.M. Moved by Maendele and seconded by Loeffelholz to deny the initial application from International Church of the Foursquare Gospel Permissive Exemption Application for parcel 60418900 due to sale of the property as determined by the County Board to meet the statutory rules as required for exemption status. Upon roll call vote, the following Board members voted "Aye": Maendele, Loeffelholz, Higgins, Kouba, Lynch, Morrow and Klein. Motion declared carried.

Chairperson Klein opened the Permissive Exemption hearing for The Outpost Foursquare at 9:48 A.M. No one addressed the Board. Chairperson Klein closed the Permissive Exemption hearing at 9:50 A.M. Moved by Maendele and seconded by Higgins to approve the Outpost Foursquare Permissive Exemption Application for parcel 60418900 as presented and as determined by the County Board to meet the statutory rules as required for exemption status. Upon roll call vote, the following Board members voted "Aye": Maendele, Higgins, Kouba, Loeffelholz, Lynch, Morrow and Klein. Motion declared carried.

Chairperson Klein opened the Permissive Exemption hearing for Family Advocacy Network at 9:50 A.M. No one addressed the Board. Chairperson Klein closed the Permissive Exemption hearing at 9:51 A.M. Moved by Loeffelholz and seconded by Morrow to approve the Family Advocacy Network Permissive Exemption Application for parcel 603665000 as presented and as determined by the County Board to meet the statutory rules as required for exemption status. Upon roll call vote, the following Board members voted "Aye": Loeffelholz, Morrow, Higgins, Kouba, Lynch, Maendele and Klein. Motion declared carried.

Chairperson Klein opened the Permissive Exemption hearing for the United Campus Ministry-University of Nebraska at 9:51 A.M. No one addressed the Board. Chairperson Klein closed the Permissive Exemption hearing at 9:52 A.M. Moved by Morrow and seconded by Kouba to approve the United Campus Ministry-University of Nebraska Permissive Exemption Application for parcel 604682000 as presented and as determined by the County Board to meet the statutory rules as required for exemption status. Upon roll call vote, the following Board members voted "Aye": Morrow, Kouba, Higgins, Loeffelholz, Lynch, Maendele and Klein. Motion declared carried.

Moved by Maendele and seconded by Higgins to approve the Valuation Change submitted by County Assessor Meusch for the following parcel numbers listed below. Upon roll call vote, the following Board members voted "Aye": Maendele, Higgins, Kouba, Loeffelholz, Lynch, Morrow and Klein. Motion declared carried.

NAME	PARCEL
ALBERT D & JUDY R DOBISH	260003000
INGALLS CROSSING DEVELOPMENT, LLC	602918700
L&P INVESTMENTS, L.L.C.	602918703
BRENNIA S HREN & MAGGIE M PELSTER	600823000
DANIEL S REITER	603250000
WILLIAM & LYNDIA M OGLE	240173360
ROBERT K & VIOLET I VANHORN	605418000
MICHAEL R BURSAW	280065100
PEDRO DAVID GARCIA LOPEZ	850001268
ALLEN ROY & PATRICIA RAE DEETS, TRS, DEETS FAMILY REV TR & DEEDS, THAD D	560092025

Moved by Loeffelholz and seconded by Higgins to approve Tax List Corrections numbered 5040 through 5042 submitted by County Assessor Meusch. Upon roll call vote, the following Board members voted "Aye": Loeffelholz, Higgins, Kouba, Lynch, Maendele, Morrow and Klein. Motion declared carried.

Moved by Maendele and seconded by Kouba to adjourn the Board of Equalization and return to the regular meeting of the Board of Commissioners at 9:54 A.M. Upon roll call vote, the following Board members voted "Aye": Maendele, Kouba, Higgins, Loeffelholz, Lynch, Morrow and Klein. Motion declared carried.

REGULAR AGENDA

Jared Reimers, District Coordinator with Congressman Adrian Smith's Office in Grand Island, gave the Board an update.

County Attorney Shawn Eatherton arrived at 10:00 A.M.

Chairperson Klein opened the Public Hearing for the Buffalo County 2023-2024 Budget Amendment at 10:00 A.M. No one addressed the Board and the public hearing was closed at 10:05 A.M.

Moved by Higgins and seconded by Morrow to approve the following budget amendment. Upon roll call vote, the following Board members voted "Aye": Higgins, Morrow, Kouba, Loeffelholz, Lynch, Maendele and Klein. Motion declared carried.

Fund	Actual	Actual	Adopted	Amended		Actual	Actual	Adopted	Amended
	Disbursements	Disbursements	Disbursements	Disbursements		Revenue	Revenue	Revenue	Revenue
	2021-2022	2022-2023	2023-2024	2023-2024		2021-2022	2022-2023	2023-2024	2023-2024
(3700) Bond Debt	1,711,883.85	1,704,092.25	1,695,141.50	1,707,938.65		2,815,082.85	2,577,568.83	2,545,141.50	2,545,141.50

Chairperson Klein reviewed the following correspondence. City of Kearney sent a letter regarding the Planning Commission Agenda for June 21, 2024. Buffalo County Historical Society sent a letter regarding a time capsule to be buried in Centennial Park in Honor of Kearney’s first 100 years on June 28, 2024 at 4:00 P.M. Nebraska Department of Transportation (NDOT) sent an invitation to participate in Section 106 Consultation via email. Project name: In Kearney West of UNK, Project No. STP-30-4(165). A copy was sent to Highway Superintendent John Maul. National Association of Counties (NACo) sent a postcard reminder about the annual business meeting on July 15, 2024 to elect 2024-2025 officers. Kinship Pointe of Northbridge sent their June event Calendar. Chairperson Klein called on each Board member present for committee reports and recommendations.

Chairperson Klein called for Citizen’s forum, a resident of Buffalo County Tom Rayburn spoke to the Board regarding his concerns with the remodel of the Buffalo County Extension Building. No one addressed the Board.

Chairperson Klein asked if there was anything else to come before the Board at 10:15 A.M. before he declared the meeting adjourned until the regular meeting at 9:00 A.M. on Tuesday, June 25, 2024.

ATTEST:

 Ivan H. Klein, Chairperson
 Buffalo County Board of Commissioners

 Heather A. Christensen
 Buffalo County Clerk

(SEAL)

JUNE 14, 2024 PAYROLL

<u>GENERAL FUND</u>			
NET PAYROLL			354,596.50
AMERICAN FAMILY LIFE	I	PREMIUMS	1,552.83
RETIREMENT PLANS AMERITAS	R	EMPE RET	62,290.46
BUFFALO CO TREASURER	I	PREMIUMS	162,672.69
EMPOWER ANNUITY INS	R	DEFERRED COMP	1,075.00
FIRST CONCORD	E	FLEX FUNDS	6,814.22
FIRST NATIONAL BANK	T	FEDERAL TAXES	119,171.94
KEARNEY UNITED WAY	E	DONATIONS	61.00
MADISON NATIONAL	I	PREMIUMS	1,151.72
MADISON NATIONAL	I	LT DISABILITY	283.17
ERIN M MCCARTNEY	E	GARNISHMENT	402.00
METLIFE	E	DENTAL	3,824.82
NATIONWIDE RETIREMENT	R	DEFERRED COMP	1,449.50
NE CHILD SUPPORT	E	CHILD SUPPORT	945.00
STATE OF NE	T	STATE TAXES	19,885.06
VISION SERVICE PLAN	E	EMPE VSP EYE	1,230.94
<u>ROAD FUND</u>			
NET PAYROLL			65,916.72
AMERICAN FAMILY LIFE	I	PREMIUMS	733.69
RETIREMENT PLANS AMERITAS	R	EMPE RET	10,294.07
BUFFALO CO TREASURER	I	PREMIUMS	4,426.97
FIRST CONCORD	E	FLEX FUNDS	891.24
FIRST NATIONAL BANK	T	FEDERAL TAXES	19,088.57
LANCASTER COUNTY COURT	E	GARNISHMENT	201.85
MADISON NATIONAL	I	PREMIUMS	167.51
MADISON NATIONAL	I	LT DISABILITY	115.12
METLIFE	E	DENTAL	982.80
NATIONWIDE RETIREMENT	R	DEFERRED COMP	272.50
STATE OF NE	T	STATE TAXES	2,873.23
VISION SERVICE PLAN	E	EMPE VSP EYE	314.14
<u>WEED FUND</u>			
NET PAYROLL			5,474.69
RETIREMENT PLANS AMERITAS	R	EMPE RET	870.45
BUFFALO CO TREASURER	I	PREMIUMS	320.65
FIRST CONCORD	E	FLEX FUNDS	104.16
FIRST NATIONAL BANK	T	FEDERAL TAXES	1,714.88
MADISON NATIONAL	I	LT DISABILITY	3.81
METLIFE	E	DENTAL	56.94
STATE OF NE	T	STATE TAXES	263.88
VISION SERVICE PLAN	E	EMPE VSP EYE	4.81

BUFFALO
BOARD PREAPPROVAL REPORT
COUNTY GENERAL
FROM 06/25/2024 TO 06/27/2024

Account # 1099	Description	Account Amt	Vendor	Invoice Description	Claim #
601-00 BOARD					
00-2-1801	DUES, SUBSCRIPT & REG	375.00	U.S. BANK	EXPENSES BOARD 4485: 594555	02406492
00-2-2000	PRINTING & PUBLISHING	1,716.11	LINCOLN JOURNAL STAR	PUBLISHING ELECTIONS 121775	02406387

	601-00 BOARD	2,091.11			

602-00 CLERK					
00-3-0101	OFFICE SUPPLIES	29.94	U.S. BANK	EXPENSES BOARD 4485: 594555	02406492

	602-00 CLERK	29.94			

603-00 TREASURER					
00-2-1704	MILEAGE	85.09	BRENDA ROHRICH	REIMBURSE SUPPLIES 3029 MIL	02406460
00-2-1801	DUES, SUBSCRIPTIONS & REGISTRAT	214.00	RAMADA BY WYNDHAM MIDTOWN	LODGING TREASURER 280118930	02406598
00-2-2000	PRINTING & PUBLISHING	6,456.08	PIP MARKETING SIGNS PRINT	SUPPLIES TREASURER 134831 1	02406446
00-3-0101	OFFICE SUPPLIES	900.17	EAKES OFFICE SOLUTIONS	SUPPLIES TREASURER 89937710	02406321
00-5-0500	OFFICE EQUIPMENT	688.62	EAKES OFFICE SOLUTIONS	SUPPLIES TREASURER 89937710	02406321
00-5-0500	OFFICE EQUIPMENT	69.94	BRENDA ROHRICH	REIMBURSE SUPPLIES 3029 MIL	02406460

	603-00 TREASURER	8,413.90			

604-00 REGISTER OF DEEDS					
00-2-1200	OFFICE EQUIPMENT REPAIR	52.99	EAKES OFFICE SOLUTIONS	SUPPLIES TREASURER 89937710	02406321
00-2-9900	MISCELLANEOUS	48.95	EAKES OFFICE SOLUTIONS	SUPPLIES TREASURER 89937710	02406321

	604-00 REGISTER OF DEEDS	101.94			

605-00 ASSESSOR					
00-2-1801	DUES, SUBSCRIPT & REG	784.20	MARSHALL & SWIFT/BOECKH,	SUBSCRIPTION ASSESSOR 11328	02406396
00-2-2000	PRINTING & PUBLISHING	2,794.64	MIPS INC.	PUBLISHING ASSESSOR 2405003	02406412
00-3-0101	OFFICE SUPPLIES	21.99	AMAZON CAPITAL SERVICES	EXPENSES ASSESSOR 11281876	02406233

	605-00 ASSESSOR	3,600.83			

607-00 ELECTION COMMISSIONER					
00-2-1801	DUES, TRAINING, REGISTRATION,	27.95	KEARNEY HUB	SUBSCRIPTION ELECTIONS 750:	02406376
00-2-2000	PRINTING & PUBLISHING	1,008.00	LINCOLN JOURNAL STAR	PUBLISHING ELECTIONS 121775	02406387
00-3-0113	VOTING SUPPLIES	264.03	U.S. BANK	EXPENSES BOARD 4485: 594555	02406492
00-5-0500	OFFICE EQUIPMENT	1,106.98	U.S. BANK	EXPENSES BOARD 4485: 594555	02406492

	607-00 ELECTION COMMISSIONER	2,406.96			

BUFFALO
BOARD PREAPPROVAL REPORT
COUNTY GENERAL
FROM 06/25/2024 TO 06/27/2024

Account #	Description	Account Amt	Vendor	Invoice Description	Claim #
610-00	DATA PROCESSING				
00-2-0200	TELEPHONE (CELL PHONE)	45.00	MANDI J AMY	REIMBURSE CELL PHONE	02406235
00-2-0200	TELEPHONE (CELL PHONE)	45.00	NATHAN AREHART	REIMBURSE CELL PHONE	02406238
00-2-0200	TELEPHONE (CELL PHONE)	45.00	DREW BOHL	REIMBURSE CELL PHONE	02406249
00-2-0200	TELEPHONE (CELL PHONE)	45.00	NATHAN BRECHT	REIMBURSE CELL PHONE	02406251
00-2-0200	TELEPHONE (CELL PHONE)	45.00	RYAN C CARSON	REIMBURSE CELL PHONE	02406269
00-2-0200	TELEPHONE (CELL PHONE)	45.00	JENNIFER CHURCH	REIMBURSE CELL PHONE	02406278
00-2-0200	TELEPHONE (CELL PHONE)	45.00	KATHARINE COLLINS	REIMBURSE CELL PHONE	02406286
00-2-0200	TELEPHONE (CELL PHONE)	45.00	DENNISE DANIELS	REIMBURSE CELL PHONE	02406298
00-2-0200	TELEPHONE (CELL PHONE)	45.00	JOSIAH DAVIS	REIMBURSE CELL PHONE	02406302
00-2-0200	TELEPHONE (CELL PHONE)	45.00	SHAWN EATHERTON	REIMBURSE CELL PHONE	02406322
00-2-0200	TELEPHONE (CELL PHONE)	45.00	PAUL FARRELL	REIMBURSE CELL PHONE	02406333
00-2-0200	TELEPHONE (CELL PHONE)	45.00	ANA FLORES CARDENAS	REIMBURSE CELL PHONE	02406337
00-2-0200	TELEPHONE (CELL PHONE)	2,824.52	FRONTIER	PHONE SVC IT 18801571105702	02406339
00-2-0200	TELEPHONE (CELL PHONE)	45.00	ANDREW W HOFFMEISTER	REIMBURSE CELL PHONE	02406354
00-2-0200	TELEPHONE (CELL PHONE)	45.00	LISA R HUERTA	REIMBURSE CELL PHONE	02406358
00-2-0200	TELEPHONE (CELL PHONE)	45.00	ERIC INGEBRETSEN	REIMBURSE CELL PHONE	02406362
00-2-0200	TELEPHONE (CELL PHONE)	25.00	KELLY KENNEDY	REIMBURSE CELL PHONE	02406378
00-2-0200	TELEPHONE (CELL PHONE)	45.00	NICK KILLOUGH	REIMBURSE CELL PHONE	02406379
00-2-0200	TELEPHONE (CELL PHONE)	45.00	DOUG KRAMER	REIMBURSE CELL PHONE	02406382
00-2-0200	TELEPHONE (CELL PHONE)	45.00	DILLON LOESCHER	REIMBURSE CELL PHONE	02406391
00-2-0200	TELEPHONE (CELL PHONE)	45.00	JOHN MARSH	REIMBURSE CELL PHONE	02406395
00-2-0200	TELEPHONE (CELL PHONE)	45.00	LYNN MARTIN	REIMBURSE CELL PHONE	02406397
00-2-0200	TELEPHONE (CELL PHONE)	45.00	KOLTON MORSE	REIMBURSE CELL PHONE	02406417
00-2-0200	TELEPHONE (CELL PHONE)	108.25	NEBRASKA CENTRAL TELEPHON	TELE SVC COMMUNICATIONS 109	02406422
00-2-0200	TELEPHONE (CELL PHONE)	45.00	ROBERT NELSON	REIMBURSE CELL PHONE	02406431
00-2-0200	TELEPHONE (CELL PHONE)	45.00	KANE M RAMSEY	REIMBURSE CELL PHONE	02406454
00-2-0200	TELEPHONE (CELL PHONE)	45.00	REBECCA RILEY	REIMBURSE CELL PHONE	02406459
00-2-0200	TELEPHONE (CELL PHONE)	45.00	BRENDA ROHRICH	REIMBURSE SUPPLIES 3029 MIL	02406460
00-2-0200	TELEPHONE (CELL PHONE)	45.00	BOWEN SCHOEN	REIMBURSE CELL PHONE	02406464
00-2-0200	TELEPHONE (CELL PHONE)	45.00	CRAIG SLEICHER	REIMBURSE CELL PHONE	02406469
00-2-0200	TELEPHONE (CELL PHONE)	45.00	MARTI SLEISTER	REIMBURSE CELL PHONE	02406470
00-2-0200	TELEPHONE (CELL PHONE)	45.00	CHERYL STABENOW	REIMBURSE CELL PHONE	02406473
00-2-0200	TELEPHONE (CELL PHONE)	714.38	VERIZON WIRELESS	PHONE SVC IT 9963789627	02406497
00-2-0200	TELEPHONE (CELL PHONE)	45.00	AARON WENTZ	REIMBURSE CELL PHONE	02406507
00-2-0200	TELEPHONE (CELL PHONE)	45.00	MELISSA L WILLIS	REIMBURSE CELL PHONE	02406511
00-2-0200	TELEPHONE (CELL PHONE)	45.00	MELANIE R YOUNG	REIMBURSE CELL PHONE	02406517
00-2-0200	TELEPHONE (CELL PHONE)	45.00	ERIC ZIKMUND	REIMBURSE CELL PHONE	02406518
00-2-1101	COMPUTER EXPENSE GENERAL (INTE	990.60	GREAT PLAINS COMMUNICATIO	TOWER SVC COMMUNICATIONS AP	02406347
00-2-1101	7 COMPUTER EXPENSE GENERAL (INTE	665.00	OPTK NETWORKS	INTERNET COMMUNICATIONS INV	02406430
00-2-1102	COMPUTER CONSULTANT (SUPPORT)	11,795.46	ABTECH TECHNOLOGIES, INC	EQUIP IT 2406027	02406227
00-2-1102	COMPUTER CONSULTANT (SUPPORT)	1,993.98	AMAZON CAPITAL SERVICES	EXPENSES ASSESSOR 11281876	02406233
00-2-1102	COMPUTER CONSULTANT (SUPPORT)	150.00	DAS ST ACCOUNTING	SUPPORT IT 1431164	02406299
00-2-1102	COMPUTER CONSULTANT (SUPPORT)	258.00	EAKES OFFICE SOLUTIONS	SUPPLIES TREASURER 89937710	02406321
00-2-1102	COMPUTER CONSULTANT (SUPPORT)	13,622.50	EEA TECHNOLOGIES INC	SVC IT 2277	02406324
00-2-1102	COMPUTER CONSULTANT (SUPPORT)	24,082.89	GOVCONNECTION INC	PROTECTION IT 17005741	02406345
00-2-2544	MAINTENANCE AGREEMENTS	190.39	CANON SOLUTIONS AMERICA,	MAINT IT 737112	02406267
00-2-2544	MAINTENANCE AGREEMENTS	6,233.36	EATON CORPORATION	MAINT IT 987329546	02406323
00-2-2544	MAINTENANCE AGREEMENTS	5,916.02	HOMETOWN LEASING	LEASE IT 036	02406356
00-2-2544	MAINTENANCE AGREEMENTS	5,838.20	MIPS INC.	PUBLISHING ASSESSOR 2405003	02406412

BUFFALO
BOARD PREAPPROVAL REPORT
COUNTY GENERAL
FROM 06/25/2024 TO 06/27/2024

Account #	Description	Account Amt	Vendor	Invoice Description	Claim #
00-2-2544	MAINTENANCE AGREEMENTS	6,111.00	YANDA'S MUSIC	EQUIP IT 705660	02406515
00-5-0315	DATA PROCESSING EQUIPMENT	730.00	MICROFILM IMAGING SYSTEMS	SCANNING IT 95193 95194 951	02406406
00-5-0315	DATA PROCESSING EQUIPMENT	70,125.30	STERLING COMPUTERS CORP	EQUIP IT 0178905	02406477
00-5-1309	DATA PROCESSING SOFTWARE	26,261.60	DELL MARKETING L.P.	EQUIP IT 10751308171	02406306
00-5-1309	DATA PROCESSING SOFTWARE	4,192.43	DLT SOLUTIONS, LLC	MAINT IT 5226911A	02406313
00-5-1309	DATA PROCESSING SOFTWARE	1,273.89	KRONOS	SVC IT 12256004	02406383
00-5-1309	DATA PROCESSING SOFTWARE	8,400.78	U.S. BANK	EXPENSES BOARD 4485: 594555	02406492
610-00 DATA PROCESSING		193,988.55			

619-00 ZONING					
00-2-1704	7 MILEAGE - BOARD OF ADJUSTMENTS	11.39	LARRY HARDESTY	REIMBURSE MILEAGE	02406351
00-2-1704	MILEAGE - BOARD OF ADJUSTMENTS	8.04	BARBARA J PEMBERTON RIEGE	REIMBURSE MILEAGE	02406442
00-2-1704	MILEAGE - BOARD OF ADJUSTMENTS	41.54	RICHARD PIERCE	REIMBURSE MILEAGE	02406445
00-2-1704	MILEAGE - BOARD OF ADJUSTMENTS	24.12	RANDALL VEST	REIMBURSE MILEAGE	02406498
00-2-1704	MILEAGE - BOARD OF ADJUSTMENTS	6.70	RICH WHITE	REIMBURSE MILEAGE	02406508
00-2-1801	DUES, SUBSCRIPTIONS, REGISTRAT	125.00	NEBRASKA FLOODPLAIN & STO	REGISTRATION ZONING 02432	02406423
00-2-2000	PRINTING & PUBLISHING	56.87	LINCOLN JOURNAL STAR	PUBLISHING ELECTIONS 121775	02406387
00-2-2000	PRINTING & PUBLISHING	27.20	U.S. BANK	EXPENSES BOARD 4485: 594555	02406492
00-3-0101	OFFICE SUPPLIES	171.27	U.S. BANK	EXPENSES BOARD 4485: 594555	02406492
00-3-0301	SIGNS	67.50	MIDWEST SERVICE & SALES C	SUPPLIES ZONING 0035642	02406410
619-00 ZONING		539.63			

621-00 CLERK OF DISTRICT COURT					
00-1-0327	9 MENTAL HEALTH BOARD	100.00	STEPHEN G LOWE	MH BOARD HEARINGS LEGAL CO	02406393
00-1-0327	7 MENTAL HEALTH BOARD	100.00	SHARON MAULER	MH BOARD HEARINGS	02406400
00-1-0327	7 MENTAL HEALTH BOARD	100.00	MANDY M MEYER	MH BOARD HEARINGS	02406405
00-2-0100	POSTAL SERVICE	436.00	U S POSTMASTER	FEE DIST COURT 520	02406491
00-2-0100	POSTAL SERVICE	475.47	U.S. BANK	EXPENSES BOARD 4485: 594555	02406492
00-2-2300	JUROR FEES	182.32	U.S. BANK	EXPENSES BOARD 4485: 594555	02406492
00-2-2401	9 COURT APPOINTED COUNCIL	30.00	STAMM ROMERO & ASSOC, P.C	LEGAL DIST COURT 4222 48264	02406474
00-3-0101	OFFICE SUPPLIES	456.85	CLERK OF THE DISTRICT COU	FEES DIST COURT 240410 2405	02406284
00-3-0101	OFFICE SUPPLIES	162.00	MORRIS PRESS	SUPPLIES DIST COURT IN02433	02406416
00-3-0101	OFFICE SUPPLIES	79.68	U.S. BANK	EXPENSES BOARD 4485: 594555	02406492
00-5-0700	FURNITURE	8,291.00	CORNHUSKER STATE INDUSTRI	FURNITURE DIST COURT 143042	02406294
621-00 CLERK OF DISTRICT COURT		10,413.32			

622-00 COUNTY COURT SYSTEM					
00-2-1801	DUES, SUBSCRIPTIONS & REGISTRA	795.79	THOMSON REUTERS-WEST	SUBSCRIPTION CO COURT 85025	02406483
00-2-2401	9 COURT APPOINTED COUNCIL	10,561.10	BRUNER FRANK SCHUMACHER,	LEGAL DIST COURT 111828 111	02406253
00-2-2401	9 COURT APPOINTED COUNCIL	1,000.00	MICHAEL D CARPER	LEGAL CO COURT JV24 60,62,6	02406268
00-2-2401	9 COURT APPOINTED COUNCIL	3,305.00	COCHRAN LAW PC, LLO	LEGAL DIST COURT 2024 0462	02406285

BUFFALO
BOARD PREAPPROVAL REPORT
COUNTY GENERAL
FROM 06/25/2024 TO 06/27/2024

Account #	Description	Account Amt	Vendor	Invoice Description	Claim #
00-2-2401	9 COURT APPOINTED COUNCIL	760.00	DEWALD DEEVER L'HEUREUX L	LEGAL CO COURT JV22 113,114	02406309
00-2-2401	9 COURT APPOINTED COUNCIL	1,490.00	DIER, OSBORN & COX, P.C.,	LEGAL CO COURT JV23 151-152	02406311
00-2-2401	9 COURT APPOINTED COUNCIL	4,420.84	BRANDON DUGAN LAW	LEGAL DIST COURT 2213 2212	02406319
00-2-2401	9 COURT APPOINTED COUNCIL	1,030.00	MARSHA FANGMEYER, ESQ.	LEGAL CO COURT JV23 140 JV2	02406331
00-2-2401	9 COURT APPOINTED COUNCIL	6,381.04	FYE LAW OFFICE	LEGAL DIST COURT 10271 1027	02406340
00-2-2401	9 COURT APPOINTED COUNCIL	20,813.16	JACOBSEN ORR LAW FIRM	LEGAL DIST COURT CI19 155 C	02406367
00-2-2401	9 COURT APPOINTED COUNCIL	24,695.00	KLEIN BREWSTER BRANDT & M	LEGAL DIST COURT 6196 6198	02406380
00-2-2401	9 COURT APPOINTED COUNCIL	1,632.55	JEFFREY C KNAPP	LEGAL CO COURT JV23 197 & 1	02406381
00-2-2401	9 COURT APPOINTED COUNCIL	1,834.02	LIESKE, LIESKE & ENSZ, PC	LEGAL DIST COURT CR24 4 CR2	02406388
00-2-2401	9 COURT APPOINTED COUNCIL	1,350.00	STEPHEN G LOWE	MH BOARD HEARINGS LEGAL CO	02406393
00-2-2401	9 COURT APPOINTED COUNCIL	2,008.27	PARKER GROSSART BAHENSKY	LEGAL DIST COURT CI13 122 C	02406441
00-2-2401	9 COURT APPOINTED COUNCIL	1,290.00	RUDOLPH LAW LLC	LEGAL CO COURT 1321 1320 13	02406462
00-2-2401	9 COURT APPOINTED COUNCIL	13,962.20	STAMM ROMERO & ASSOC, P.C	LEGAL DIST COURT 4222 48264	02406474
00-2-2401	9 COURT APPOINTED COUNCIL	1,932.93	THOMAS S STEWART	LEGAL DIST COURT 5840 582?	02406478
00-2-2401	9 COURT APPOINTED COUNCIL	1,002.54	MICHAEL J SYNEK	LEGAL DIST COURT CI24 77 CI	02406481
00-2-2401	9 COURT APPOINTED COUNCIL	300.00	CHRISTINA L. THORNTON	LEGAL CO COURT CR23 1899 JV	02406485
00-2-2401	9 COURT APPOINTED COUNCIL	1,875.00	REBECCA TVRDIK ANDERSON	LEGAL CO COURT JV16 201 JV2	02406489
00-2-2401	9 COURT APPOINTED COUNCIL	4,517.53	TYE & ROWLING, PC, LLO	LEGAL DIST COURT 25712 2571	02406490
00-3-0101	OFFICE SUPPLIES	3,560.67	EAKES OFFICE SOLUTIONS	SUPPLIES TREASURER 89937710	02406321
622-00 COUNTY COURT SYSTEM		110,517.64			
625-00 PUBLIC DEFENDER					
00-2-1700	TRAVEL	254.00	U.S. BANK	EXPENSES BOARD 4485: 594555	02406492
00-2-1704	MILEAGE	78.81	D. BRANDON BRINEGAR	REIMBURSE MILEAGE	02406252
00-2-1704	MILEAGE	20.78	SHARON JOSEPH	REIMBURSE MILEAGE	02406371
00-2-1704	MILEAGE	70.67	MICHELLE MITCHELL	REIMBURSE MILEAGE	02406414
00-2-1801	DUES, SUBSCRIPTIONS & REGISTRA	246.00	JUSTICE WORKS LLC	DEFENDER DATA PUB DEFENDER	02406372
00-2-1801	DUES, SUBSCRIPTIONS & REGISTRA	813.05	THOMSON REUTERS - WEST	SUBSCRIPTION PUB DEFENDER 8	02406484
00-2-2600	COURT COSTS	544.87	U.S. BANK	EXPENSES BOARD 4485: 594555	02406492
00-3-0101	OFFICE SUPPLIES	3.62	U.S. BANK	EXPENSES BOARD 4485: 594555	02406492
625-00 PUBLIC DEFENDER		2,031.80			
641-00 BUILDING & GROUNDS					
00-2-0501	LIGHTS	2,731.25	DAWSON PUBLIC POWER DISTR	UTILITIES B&G 9428	02406304
00-2-0501	LIGHTS	14,057.67	NEBRASKA PUBLIC POWER DIS	UTILITIES B&G 311010034000	02406428
00-2-0502	WATER	4,017.40	CITY OF KEARNEY	UTILITIES B&G 151182000001	02406280
00-2-0502	WATER	25.00	VILLAGE OF MILLER	UTILITIES B&G MAY 2024	02406499
00-2-0503	HEATING FUELS	1,335.15	NORTHWESTERN ENERGY	UTILITIES B&G 29350972 2660	02406436
00-2-0503	HEATING FUELS	1,314.92	U.S. BANK	EXPENSES BOARD 4485: 594555	02406492
00-2-0505	GARBAGE (LANDFILL USE)	22.25	DAN'S SANITATION, INC	SVC B&G MILLER SHED 9378638	02406296
00-2-0505	GARBAGE (LANDFILL USE)	62.08	SOLID WASTE AGENCY LANDFI	DEMO B&G 410480 411432 4118	02406472
00-2-1300	BUILDING REPAIR (COURTHOUSE)	18.77	ACE HARDWARE & GARDEN CEN	SUPPLIES B&G 429137	02406228
00-2-1300	BUILDING REPAIR (COURTHOUSE)	2,115.27	BANNER SOLUTIONS	EQUIP B&G 12067366 12077600	02406248
00-2-1300	BUILDING REPAIR (COURTHOUSE)	59.00	CULLIGAN OF KEARNEY	SUPPLIES B&G 116251 133694	02406295

BUFFALO
BOARD PREAPPROVAL REPORT
COUNTY GENERAL
FROM 06/25/2024 TO 06/27/2024

Account #	Description	Account Amt	Vendor	Invoice Description	Claim #
00-2-1300	7 BUILDING REPAIR (COURTHOUSE)	107,523.90	DUNCAN THEIS CONSTRUCTION	CONSTRUCTION B&G APP 1 APP	02406320
00-2-1300	BUILDING REPAIR (COURTHOUSE)	1,039.20	JOHNSTONE SUPPLY	SUPPLIES B&G 6218986 621900	02406369
00-2-1300	BUILDING REPAIR (COURTHOUSE)	250.00	KEARNEY WINNELSON CO	PARTS B&G 45025301 45036701	02406377
00-2-1300	BUILDING REPAIR (COURTHOUSE)	55.05	MENARDS - KEARNEY	SUPPLIES EXT OFFICE 72588 B	02406404
00-2-1300	7 BUILDING REPAIR (COURTHOUSE)	21,290.00	OAK CREEK ENGINEERING, LL	ENGINEERING B&G INV 24 121	02406438
00-2-1300	BUILDING REPAIR (COURTHOUSE)	134.72	SHERWIN WILLIAMS	SUPPLIES B&G 01543 01709	02406467
00-2-1300	BUILDING REPAIR (COURTHOUSE)	1,051.70	STEINBRINK LANDSCAPING, I	SUPPLIES B&G 11278 11282	02406476
00-2-1300	BUILDING REPAIR (COURTHOUSE)	2,207.96	U.S. BANK	EXPENSES BOARD 4485: 594555	02406492
00-2-1300	BUILDING REPAIR (COURTHOUSE)	1,082.09	THE WALDINGER CORPORATION	REPAIRS B&G 14815860 727853	02406501
00-2-1300	BUILDING REPAIR (COURTHOUSE)	1,798.83	WILKINS ARCHITECTURE DESI	RENOVATION B&G 9096 6097 60	02406510
00-2-1302	BUILDING REPAIR (JAIL)	139.91	ASK SUPPLY CO. LLC	SUPPLIES B&G 24331	02406241
00-2-1302	BUILDING REPAIR (JAIL)	334.00	CULLIGAN OF KEARNEY	SUPPLIES B&G 116251 133694	02406295
00-2-1302	BUILDING REPAIR (JAIL)	470.40	DASH MEDICAL GLOVES	SUPPLIES B&G 1310943 131095	02406301
00-2-1302	BUILDING REPAIR (JAIL)	898.21	EAKES OFFICE SOLUTIONS	SUPPLIES TREASURER 89937710	02406321
00-2-1302	BUILDING REPAIR (JAIL)	165.00	INTEGRATED CONTROLS, LLC	SVC B&G 6690 6713	02406363
00-2-1302	BUILDING REPAIR (JAIL)	186.73	JOHNSTONE SUPPLY	SUPPLIES B&G 6218986 621900	02406369
00-2-1302	BUILDING REPAIR (JAIL)	30.00	KEARNEY WINNELSON CO	PARTS B&G 45025301 45036701	02406377
00-2-1302	BUILDING REPAIR (JAIL)	29.99	MENARDS - KEARNEY	SUPPLIES EXT OFFICE 72588 B	02406404
00-2-1302	BUILDING REPAIR (JAIL)	965.00	RAPID FIRE PROTECTION INC	PARTS B&G 69660	02406455
00-2-1304	OTHER BUILDING REPAIR (RYDE)	1,044.19	AMAZON CAPITAL SERVICES	EXPENSES ASSESSSOR 11281876	02406233
00-2-1304	OTHER BUILDING REPAIR (RYDE)	270.76	AMERICAN ELECTRIC COMPANY	SUPPLIES B&G 3595: 103517 1	02406234
00-2-1304	7 OTHER BUILDING REPAIR (RYDE)	83,500.00	B & S CONCRETE	CONCRETE B&G 1759	02406247
00-2-1304	OTHER BUILDING REPAIR (RYDE)	89.04	CENTURY LUMBER CENTER	SUPPLIES B&G 10937001 11053	02406272
00-2-1304	OTHER BUILDING REPAIR (RYDE)	12,480.00	DON WASSON CO	SUPPLIES B&G 5402401	02406315
00-2-1304	7 OTHER BUILDING REPAIR (RYDE)	19,001.25	INTEGRATED CONTROLS, LLC	SVC B&G 6690 6713	02406363
00-2-1304	OTHER BUILDING REPAIR (RYDE)	473.47	JOHNSTONE SUPPLY	SUPPLIES B&G 6218986 621900	02406369
00-2-1304	OTHER BUILDING REPAIR (RYDE)	26.59	KEARNEY WINNELSON CO	PARTS B&G 45025301 45036701	02406377
00-2-1304	OTHER BUILDING REPAIR (RYDE)	7.90	MASTERS TRUE VALUE	SUPPLIES B&G 2405: 059826 0	02406398
00-2-1304	OTHER BUILDING REPAIR (RYDE)	113.46	MENARDS - KEARNEY	SUPPLIES EXT OFFICE 72588 B	02406404
00-2-1304	OTHER BUILDING REPAIR (RYDE)	9,347.52	MID NEBRASKA AGGREGATE IN	SUPPLIES B&G 240720	02406407
00-2-1304	7 OTHER BUILDING REPAIR (RYDE)	124,000.00	YOUNG ELECTRIC	RENOVATION B&G 1241 1242	02406516
00-2-1305	BUILDING REPAIR (MIDTOWN)	1,017.00	AMAZON CAPITAL SERVICES	EXPENSES ASSESSSOR 11281876	02406233
00-2-1305	BUILDING REPAIR (MIDTOWN)	58.50	AMERICAN ELECTRIC COMPANY	SUPPLIES B&G 3595: 103517 1	02406234
00-2-1305	BUILDING REPAIR (MIDTOWN)	1,696.50	BUFFALO COUNTY FACILITIES	UTILITIES B&G 2088 2089 290	02406263
00-2-1305	BUILDING REPAIR (MIDTOWN)	36.30	CONSTRUCTION RENTAL INC	EQUIP B&G 4879642 4884182 4	02406291
00-2-1305	BUILDING REPAIR (MIDTOWN)	15.58	ENTERPRISE ELECTRIC KEARN	SUPPLIES B&G 3597: 1024369	02406327
00-2-1305	BUILDING REPAIR (MIDTOWN)	188.00	INTEGRATED SECURITY SOLUT	EQUIP B&G 20242044 20241683	02406364
00-2-1305	7 BUILDING REPAIR (MIDTOWN)	1,625.00	ISAAC CONSTRUCTION	CONSTRUCTION B&G 2266 2292	02406366
00-2-1305	BUILDING REPAIR (MIDTOWN)	32.06	KEARNEY WINNELSON CO	PARTS B&G 45025301 45036701	02406377
00-2-1305	BUILDING REPAIR (MIDTOWN)	50.05	MASTERS TRUE VALUE	SUPPLIES B&G 2405: 059826 0	02406398
00-2-1305	BUILDING REPAIR (MIDTOWN)	658.74	MENARDS - KEARNEY	SUPPLIES EXT OFFICE 72588 B	02406404
00-2-1305	BUILDING REPAIR (MIDTOWN)	55,725.00	NEBRASKA GENERATOR SERVIC	MAINT B&G 15259 16748 16749	02406424
00-2-1305	BUILDING REPAIR (MIDTOWN)	15,750.00	YOUNG ELECTRIC	RENOVATION B&G 1241 1242	02406516
00-2-1306	BUILDING REPAIR (EXTENSION)	1,250.00	BUFFALO COUNTY FACILITIES	UTILITIES B&G 2088 2089 290	02406263
00-2-1306	BUILDING REPAIR (EXTENSION)	32.95	CONSTRUCTION RENTAL INC	EQUIP B&G 4879642 4884182 4	02406291
00-2-1306	7 BUILDING REPAIR (EXTENSION)	140,085.90	DUNCAN THEIS CONSTRUCTION	CONSTRUCTION B&G APP 1 APP	02406320
00-2-1306	BUILDING REPAIR (EXTENSION)	250.00	KEARNEY WINNELSON CO	PARTS B&G 45025301 45036701	02406377
00-2-1306	BUILDING REPAIR (EXTENSION)	15.00	PLATTE VALLEY COMMUNICATI	EQUIP COMMUNICATIONS 062400	02406449
00-2-1306	BUILDING REPAIR (EXTENSION)	2,891.34	WILKINS ARCHITECTURE DESI	RENOVATION B&G 9096 6097 60	02406510
00-2-1307	BUILDING REPAIR (HHS)	489.29	KEARNEY WINNELSON CO	PARTS B&G 45025301 45036701	02406377

BUFFALO
BOARD PREAPPROVAL REPORT
COUNTY GENERAL
FROM 06/25/2024 TO 06/27/2024

Account #	Description	Account Amt	Vendor	Invoice Description	Claim #
00-2-1307	BUILDING REPAIR (HHS)	15.16	MASTERS TRUE VALUE	SUPPLIES B&G 2405: 059826 0	02406398
00-2-1307	BUILDING REPAIR (HHS)	154.47	MENARDS - KEARNEY	SUPPLIES EXT OFFICE 72588 B	02406404
00-2-1308	ROAD BUILDING REPAIR	52,280.00	LOGAN CONTRACTORS SUPPLY	SUPPLIES B&G D93080	02406392
00-2-1310	BUILDING REPAIR (OLD PROBATION	1,441.44	WILKINS ARCHITECTURE DESI	RENOVATION B&G 9096 6097 60	02406510
00-2-1311	BUILDING REPAIR (MAINTENANCE B	423.19	KEARNEY WINNELSON CO	PARTS B&G 45025301 45036701	02406377
00-2-1311	BUILDING REPAIR (MAINTENANCE B	79.99	MENARDS - KEARNEY	SUPPLIES EXT OFFICE 72588 B	02406404
00-2-1312	BUILDING REPAIR (PW)	947.50	AREA SERVICES INC	SVC B&G 13983	02406237
00-2-1312	BUILDING REPAIR (PW)	27.44	BUILDERS WAREHOUSE INC	SUPPLIES B&G 1635991 163841	02406266
00-2-1312	BUILDING REPAIR (PW)	385.00	COMFY BOWL, INC	RENT B&G 88582	02406287
00-2-1312	BUILDING REPAIR (PW)	277.56	FARMERS COOPERATIVE ASSOC	FUEL B&G 995094 1002287 100	02406332
00-2-1312	BUILDING REPAIR (PW)	28,509.50	GRAND KUBOTA	VEHICLE B&G CGK0	02406346
00-2-1312	BUILDING REPAIR (PW)	122.74	LARSEN ELECTRIC INC	PARTS B&G 1823	02406386
00-2-1312	BUILDING REPAIR (PW)	272.79	MEAD LUMBER	SUPPLIES B&G 10659151	02406403
00-2-1312	BUILDING REPAIR (PW)	6,625.51	MENARDS - KEARNEY	SUPPLIES EXT OFFICE 72588 B	02406404
00-2-1312	BUILDING REPAIR (PW)	12,500.00	JASON BARENT	SVC B&G INV 93 INV 94 INV 9	02406439
00-2-1312	BUILDING REPAIR (PW)	39.99	U.S. BANK	EXPENSES BOARD 4485: 594555	02406492
00-2-1312	BUILDING REPAIR (PW)	258.04	WILKE'S TRUE VALUE	SUPPLIES B&G 2405086911 240	02406509
00-2-1313	BUILDING REPAIR (COMM TOWER BL	65.83	AXMANN HEATING & AIR COND	SUPPLIES B&G 12949	02406246
00-2-1313	BUILDING REPAIR (COMM TOWER BL	14.44	MENARDS - KEARNEY	SUPPLIES EXT OFFICE 72588 B	02406404
00-2-1810	UNIFORM CLEANING/PURCHASE	4,277.00	MOONLIGHT CUSTOM SCREENPR	SVC BCSO 21505 21523 21562	02406415
00-2-2544	MAINTENANCE AGREEMENTS-ELEVATO	928.69	CHEMSEARCHFE	SVC B&G 8705397	02406275
00-2-2544	MAINTENANCE AGREEMENTS-ELEVATO	208.00	INTEGRATED SECURITY SOLUT	EQUIP B&G 20242044 20241683	02406364
00-2-2544	MAINTENANCE AGREEMENTS-ELEVATO	2,974.75	NEBRASKA GENERATOR SERVIC	MAINT B&G 15259 16748 16749	02406424
00-2-2544	MAINTENANCE AGREEMENTS-ELEVATO	123.90	TK ELEVATOR CORPORATION	MAINT B&G 1000612443	02406486
00-2-2544	MAINTENANCE AGREEMENTS-ELEVATO	7,838.00	THE WALDINGER CORPORATION	REPAIRS B&G 14815860 727853	02406501
00-2-9900	MISCELLANEOUS	259.60	AMAZON CAPITAL SERVICES	EXPENSES ASSESSOR 11281876	02406233
00-2-9900	MISCELLANEOUS	151.88	MENARDS - KEARNEY	SUPPLIES EXT OFFICE 72588 B	02406404
00-2-9900	MISCELLANEOUS	28,074.88	WILKINS ARCHITECTURE DESI	RENOVATION B&G 9096 6097 60	02406510
00-3-0101	OFFICE SUPPLIES	47.98	EAKES OFFICE SOLUTIONS	SUPPLIES TREASURER 89937710	02406321
00-3-0101	OFFICE SUPPLIES	39.99	U.S. BANK	EXPENSES BOARD 4485: 594555	02406492
00-3-0103	JANITORIAL SUPPLIES	52.16	AMAZON CAPITAL SERVICES	EXPENSES ASSESSOR 11281876	02406233
00-3-0103	JANITORIAL SUPPLIES	917.39	DASH MEDICAL GLOVES	SUPPLIES B&G 1310943 131095	02406301
00-3-0103	JANITORIAL SUPPLIES	6,599.72	EAKES OFFICE SOLUTIONS	SUPPLIES TREASURER 89937710	02406321
00-3-0103	JANITORIAL SUPPLIES	315.72	MENARDS - KEARNEY	SUPPLIES EXT OFFICE 72588 B	02406404
00-3-0103	JANITORIAL SUPPLIES	75.99	U.S. BANK	EXPENSES BOARD 4485: 594555	02406492
00-3-0120	GROUNDS SUPPLIES	192.00	CONSTRUCTION RENTAL INC	EQUIP B&G 4879642 4884182 4	02406291
00-3-0120	GROUNDS SUPPLIES	192.56	ENTERPRISE ELECTRIC KEARN	SUPPLIES B&G 3597: 1024369	02406327
00-3-0120	GROUNDS SUPPLIES	55.57	NIKKI FRIEND	REIMBURSE B&G 1718262	02406338
00-3-0120	GROUNDS SUPPLIES	79.21	HOLMES PLUMBING & HEATING	SUPPLIES B&G 329004	02406355
00-3-0120	GROUNDS SUPPLIES	185.00	KEARNEY WINNELSON CO	PARTS B&G 45025301 45036701	02406377
00-3-0120	GROUNDS SUPPLIES	14.66	LANDMARK IMPLEMENT INC	PARTS B&G 11723967	02406385
00-3-0120	GROUNDS SUPPLIES	321.69	MENARDS - KEARNEY	SUPPLIES EXT OFFICE 72588 B	02406404
00-5-0319	JANITORIAL EQUIPMENT	360.86	MENARDS - KEARNEY	SUPPLIES EXT OFFICE 72588 B	02406404

641-00 BUILDING & GROUNDS

796,360.63

645-00 COOPERATIVE EXTENSION
00-2-0100 POSTAL SERVICES

51.60 MIDWEST CONNECT, LLC POSTAGE EXT OFFICE BC05 5/1 02406409

BUFFALO
BOARD PREAPPROVAL REPORT
COUNTY GENERAL
FROM 06/25/2024 TO 06/27/2024

Account #	Description	Account Amt	Vendor	Invoice Description	Claim #
00-2-1801	DUES, SUBSCRIPTIONS & REG.	10.34	LINCOLN JOURNAL STAR	PUBLISHING ELECTIONS 121775	02406387
00-3-0101	OFFICE SUPPLIES	50.03	EAKES OFFICE SOLUTIONS	SUPPLIES TREASURER 89937710	02406321
00-3-0124	PROGRAM SUPPLIES	30.61	MENARDS - KEARNEY	SUPPLIES EXT OFFICE 72588 B	02406404
00-3-0124	PROGRAM SUPPLIES	562.45	U.S. BANK	EXPENSES BOARD 4485: 594555	02406492
645-00 COOPERATIVE EXTENSION		705.03			

651-00 SHERIFF					
00-2-1700	TRAVEL EXPENSES	944.75	BUFFALO COUNTY CLERK	PER DIEM BCSO 1647 1648 164	02406261
00-2-1700	TRAVEL EXPENSES	67.55	BUFFALO COUNTY SHERIFF	EXPENSES BCSO 1073 1074 107	02406264
00-2-1700	TRAVEL EXPENSES	1,185.48	U.S. BANK	EXPENSES BOARD 4485: 594555	02406492
00-2-1700	TRAVEL EXPENSES	280.94	WELLS FARGO	EXPENSES BCSO CC 8950	02406503
00-2-1801	DUES, SUBSCRIPTION & REG	500.00	BUFFALO COUNTY SHERIFF	EXPENSES BCSO 1073 1074 107	02406264
00-2-1801	DUES, SUBSCRIPTION & REG	30.00	WELLS FARGO	EXPENSES CC 3346	02406505
00-2-1810	UNIFORM CLEANING/PURCHASE	1,153.73	GALLS, LLC	EQUIP BCSO 27937931 2794001	02406341
00-2-1810	UNIFORM CLEANING/PURCHASE	70.75	IDEAL PROFESSIONAL CLEANER	SVC BCSO 6441	02406360
00-2-1810	UNIFORM CLEANING/PURCHASE	1,800.50	MOONLIGHT CUSTOM SCREENPR	SVC BCSO 21505 21523 21562	02406415
00-2-1810	UNIFORM CLEANING/PURCHASE	595.50	U.S. BANK	EXPENSES BOARD 4485: 594555	02406492
00-2-1810	UNIFORM CLEANING/PURCHASE	104.08	VILLAGE UNIFORM	EQUIP BCSO 595624 596103 59	02406500
00-2-2418	SHERIFF CASE FEES	3,555.18	BUFFALO COUNTY SHERIFF	FEES BCSO MAY 2024	02406265
00-2-2901	LAW ENFORCEMENT COSTS - COUNTY	1,695.60	ARISKA, LLC	EQUIP BCSO 2024 11	02406239
00-2-2901	LAW ENFORCEMENT COSTS - COUNTY	527.79	AT&T MOBILITY	PHONE SVC BCSO 287298012011	02406242
00-2-2901	LAW ENFORCEMENT COSTS - COUNTY	27.10	BUFFALO COUNTY SHERIFF	EXPENSES BCSO 1073 1074 107	02406264
00-2-2901	LAW ENFORCEMENT COSTS - COUNTY	20.00	CIOX HEALTH	EXPENSES BCSO 460136834 CO	02406279
00-2-2901	LAW ENFORCEMENT COSTS - COUNTY	3,260.45	DANA SAFETY SUPPLY, INC	EQUIP BCSO 202408	02406297
00-2-2901	LAW ENFORCEMENT COSTS - COUNTY	1,323.40	DEFENSE TECHNOLOGY	EQUIP BCSO 202409	02406305
00-2-2901	LAW ENFORCEMENT COSTS - COUNTY	162.00	INTERSTATE ALL BATTERY CE	SUPPLIES BCSO 1905899024687	02406365
00-2-2901	LAW ENFORCEMENT COSTS - COUNTY	218.98	LINCOLN JOURNAL STAR	PUBLISHING ELECTIONS 121775	02406387
00-2-2901	LAW ENFORCEMENT COSTS - COUNTY	39.55	MENARDS - KEARNEY	SUPPLIES EXT OFFICE 72588 B	02406404
00-2-2901	LAW ENFORCEMENT COSTS - COUNTY	45.45	PLATINUM AWARDS & GIFTS	SUPPLIES BCSO 20350	02406447
00-2-2901	LAW ENFORCEMENT COSTS - COUNTY	1,095.10	U.S. BANK	EXPENSES BOARD 4485: 594555	02406492
00-2-2901	LAW ENFORCEMENT COSTS - COUNTY	1,105.42	EPHRAIM VALENZUELA	REIMBURSE EXPENSES	02406494
00-2-2901	LAW ENFORCEMENT COSTS - COUNTY	736.04	WELLS FARGO	EXPENSES BCSO CC 8950	02406503
00-2-2912	SHERIFF'S TRAINING SCHOOL	45.40	CONSOLIDATED MANAGEMENT C	FOOD SVC BCSO 2401791 24019	02406290
00-2-2912	SHERIFF'S TRAINING SCHOOL	560.00	NEBRASKA LAW ENFORCEMENT	TRAINING BCSO 13675 13684 1	02406426
00-3-0101	OFFICE SUPPLIES	698.64	ALL MAKES OFFICE EQUIPMEN	FURNITURE BCSO L27670	02406231
00-3-0101	OFFICE SUPPLIES	99.14	AMAZON CAPITAL SERVICES	EXPENSES ASSESSOR 11281876	02406233
00-3-0101	OFFICE SUPPLIES	86.35	QUILL CORPORATION	SUPPLIES BCSO 38550671 EM 3	02406453
00-3-0101	OFFICE SUPPLIES	621.66	RR DONNELLEY	APPLICATION BCSO 111981272	02406461
00-3-0209	MACHINERY & EQUIPMENT FUEL	10,217.18	CITY OF KEARNEY	FUEL BCSO 2024: 00000081 EM	02406281
00-3-0209	MACHINERY & EQUIPMENT FUEL	46.00	U.S. BANK	EXPENSES BOARD 4485: 594555	02406492
00-3-0209	MACHINERY & EQUIPMENT FUEL	35.12	WELLS FARGO	EXPENSES BCSO CC 8950	02406503
00-3-0210	MACHINERY & EQUIPMENT GREASE-O	461.99	ATS	SVC BCSO 66607 66662 66718	02406243
00-3-0210	MACHINERY & EQUIPMENT GREASE-O	119.96	NAPA AUTO PARTS	PARTS BCSO 757545 757549 75	02406421
00-3-0211	MACHINERY & EQUIPMENT TIRES-RE	4,706.92	GARRETT TIRES & TREADS -	REPAIRS BCSO 2147281 214780	02406343
00-3-0212	EQUIPMENT REPAIR	465.00	ALL STAR AUTO GLASS OF GR	SVC BCSO WAS3054824	02406232
00-3-0212	EQUIPMENT REPAIR	511.79	AUTO VALUE PARTS STORE	SUPPLIES BCSO 76NV171039	02406244
00-3-0212	EQUIPMENT REPAIR	1,778.40	BS & K SIGNS INC	EQUIP BCSO 19231 19232	02406256

BUFFALO
BOARD PREAPPROVAL REPORT
COUNTY GENERAL
FROM 06/25/2024 TO 06/27/2024

Account # 1099	Description	Account Amt	Vendor	Invoice Description	Claim #
00-3-0212	EQUIPMENT REPAIR	1,011.71	MIDWAY CHRYSLER DODGE JEE	EQUIP BCSO 136940 13921	02406408
00-3-0212	EQUIPMENT REPAIR	510.06	MIRROR IMAGE CAR WASH	SERVICES BCSO 1891049 BOARD	02406413
00-3-0212	EQUIPMENT REPAIR	1,059.20	NAPA AUTO PARTS	PARTS BCSO 757545 757549 75	02406421
00-3-0212	EQUIPMENT REPAIR	25.86	PLATTE VALLEY COMMUNICATI	EQUIP COMMUNICATIONS 062400	02406449
00-3-0212	EQUIPMENT REPAIR	300.00	PRO-TINT	SVC BCSO 210706 210705	02406451
00-3-0212	EQUIPMENT REPAIR	180.83	U.S. BANK	EXPENSES BOARD 4485: 594555	02406492
00-3-0212	EQUIPMENT REPAIR	162.90	WINZER	SUPPLIES BCSO 2120616	02406512
00-5-0400	ENGINEERING & TECH EQUIPMENT	5,257.16	AMAZON CAPITAL SERVICES	EXPENSES ASSESSOR 11281876	02406233
00-5-0400	ENGINEERING & TECH EQUIPMENT	3,032.48	MALLORY SAFETY & SUPPLY L	EQUIP BCSO 5918092 3563935	02406394
00-5-0400	ENGINEERING & TECH EQUIPMENT	6,035.64	MOTOROLA SOLUTIONS, INC	EQUIP BCSO 8330279918	02406418
00-5-0400	ENGINEERING & TECH EQUIPMENT	4,087.36	U.S. BANK	EXPENSES BOARD 4485: 594555	02406492
00-5-0400	ENGINEERING & TECH EQUIPMENT	23,297.80	UNMANNED VEHICLE TECHNOLO	EQUIP BCSO 202407	02406493
00-5-0400	ENGINEERING & TECH EQUIPMENT	2,798.00	WELLS FARGO	EXPENSES BCSO CC 8950	02406503
00-5-0400	ENGINEERING & TECH EQUIPMENT	3,246.60	WELLS FARGO	INTERNET BCSO CC 2877 EQUIP	02406504

651-00 SHERIFF 92,004.49

652-00 ATTORNEY					
00-2-0100	POSTAL SERVICE	299.00	U.S. BANK	EXPENSES BOARD 4485: 594555	02406492
00-2-1700	TRAVEL EXPENSE	160.00	BUFFALO COUNTY CLERK	PER DIEM BCSO 1647 1648 164	02406261
00-2-1700	TRAVEL EXPENSE	2,430.86	U.S. BANK	EXPENSES BOARD 4485: 594555	02406492
00-2-1801	DUES, SUBSCRIPTIONS & REG.	1,000.00	FAMILY ADVOCACY NETWORK	FEE BCSO 2024 CO ATTORNEY 2	02406330
00-2-1801	DUES, SUBSCRIPTIONS & REG.	243.50	MATTHEW BENDER & CO, INC	SUPPLIES CO ATTORNEY 412268	02406399
00-2-1801	DUES, SUBSCRIPTIONS & REG.	5,007.80	THOMSON REUTERS - WEST	SUBSCRIPTION CO ATTORNEY 85	02406482
00-2-2600	COURT COSTS	40.07	CIOX HEALTH	EXPENSES BCSO 460136834 CO	02406279
00-2-2600	COURT COSTS	70.89	DAWSON COUNTY SHERIFF'S O	FEEES CO ATTORNEY 50867	02406303
00-2-2600	COURT COSTS	34.30	DOUGLAS COUNTY SHERIFF	FEEES CO ATTORNEY 147670 148	02406317
00-2-2600	7 COURT COSTS	125.65	ELITE COURT REPORTING SER	SVC CO ATTORNEY 17978	02406325
00-2-2600	COURT COSTS	68.40	KEARNEY COUNTY SHERIFF'S	FEE CO ATTORNEY 10308	02406373
00-2-2600	COURT COSTS	72.40	LINCOLN JOURNAL STAR	PUBLISHING ELECTIONS 121775	02406387
00-2-2600	COURT COSTS	65.79	THE NORTH PLATTE TELEGRAP	PUBLICATION CO ATTORNEY 121	02406434
00-2-2600	COURT COSTS	18.50	PHELPS COUNTY SHERIFF'S O	FEE CO ATTORNEY CR23 2165	02406443
00-2-2600	7 COURT COSTS	108.50	CONNIE S SCHUMAN	LEGAL CO ATTORNEY CR23 84	02406465
00-2-2600	COURT COSTS	18.50	SEWARD COUNTY SHERIFF	FEEES CO ATTORNEY INV2024007	02406466
00-2-2600	COURT COSTS	84.77	U.S. BANK	EXPENSES BOARD 4485: 594555	02406492
00-3-0101	OFFICE SUPPLIES	1,568.74	EAKES OFFICE SOLUTIONS	SUPPLIES TREASURER 89937710	02406321
00-3-0101	OFFICE SUPPLIES	102.83	LIPS PRINTING SERVICE	SUPPLIES CO ATTORNEY 102179	02406390
00-5-0315	DATA PROCESSING EQUIPMENT	395.91	U.S. BANK	EXPENSES BOARD 4485: 594555	02406492

652-00 ATTORNEY 11,916.41

653-00 COMMUNICATION CENTER					
00-2-0200	TELEPHONE SERVICE	86.43	AT&T MOBILITY	PHONE SVC BCSO 287298012011	02406242
00-2-0200	TELEPHONE SERVICE	99.98	CHARTER COMMUNICATIONS	PHONE SVC COMMUNICATIONS 17	02406274
00-2-0200	TELEPHONE SERVICE	2,577.48	ESCHAT	SUBSCRIPTION COMMUNICATIONS	02406328
00-2-0200	TELEPHONE SERVICE	1,076.81	FRONTIER	PHONE SVC IT 18801571105702	02406339

BUFFALO
BOARD PREAPPROVAL REPORT
COUNTY GENERAL
FROM 06/25/2024 TO 06/27/2024

Account #	Description	Account Amt	Vendor	Invoice Description	Claim #
00-2-0400	RADIO REPAIR	14,289.96	PLATTE VALLEY COMMUNICATI	EQUIP COMMUNICATIONS 062400	02406449
00-2-0609	MAINTENANCE AND REPAIRS	219.96	CITY OF KEARNEY	EQUIP COMMUNICATIONS 113338	02406282
00-2-0609	MAINTENANCE AND REPAIRS	260.82	FIBER PLATFORM, LLC	EQUIP COMMUNICATIONS SI2401	02406335
00-2-0609	MAINTENANCE AND REPAIRS	1,349.25	GREAT PLAINS COMMUNICATIO	TOWER SVC COMMUNICATIONS AP	02406347
00-2-0609	7 MAINTENANCE AND REPAIRS	588.24	OPTK NETWORKS	INTERNET COMMUNICATIONS INV	02406430
00-2-0609	MAINTENANCE AND REPAIRS	1,283.89	U.S. BANK	EXPENSES BOARD 4485: 594555	02406492
00-2-0609	MAINTENANCE AND REPAIRS	62.00	WPCI	SCREENING COMMUNICATIONS MA	02406514
00-2-1100	DATA PROCESSING COSTS	960.00	DAS STATE ACCTNG-CENTRAL	DAS BCSO 1428085	02406300
00-2-1801	DUES, SUBSC, REGIST, TRAINING,	198.00	BUFFALO COUNTY CLERK	PER DIEM BCSO 1647 1648 164	02406261
00-2-1801	DUES, SUBSC, REGIST, TRAINING,	99.00	WELLS FARGO	EXPENSES CC 3346	02406505
00-2-1810	UNIFORM CLEANING/PURCHASE	232.81	GALLS, LLC	EQUIP BCSO 27937931 2794001	02406341
00-2-2912	SHERIFF'S TRAINING SCHOOL	1,218.50	U.S. BANK	EXPENSES BOARD 4485: 594555	02406492
00-4-0206	COMMUNICATION EQUIPMENT - RENT	220.44	MARVCO ENTERPRISED, INC.	SUPPLIES COMMUNICATIONS 132	02406245
00-4-0206	COMMUNICATION EQUIPMENT - RENT	8,199.82	HIGH MAINTENANCE & MODS,	MAINT COMMUNICATIONS 2748 R	02406353
00-4-0206	7 COMMUNICATION EQUIPMENT - RENT	1,375.00	HIGH MAINTENANCE & MODS,	MAINT COMMUNICATIONS 2748 R	02406353
00-4-0206	COMMUNICATION EQUIPMENT - RENT	1,464.00	MOTOROLA SOLUTIONS, INC	EQUIP BCSO 8330279918	02406418
00-4-0206	COMMUNICATION EQUIPMENT - RENT	74.95	NEBRASKA CENTRAL TELEPHON	TELE SVC COMMUNICATIONS 109	02406422
00-4-0206	COMMUNICATION EQUIPMENT - RENT	3,738.00	NO LIMITS TOWER SERVICE	MAINT COMMUNICATIONS 291 29	02406433
00-4-0206	7 COMMUNICATION EQUIPMENT - RENT	2,744.00	NO LIMITS TOWER SERVICE	MAINT COMMUNICATIONS 291 29	02406433
653-00 COMMUNICATION CENTER		42,419.34			

671-00 COUNTY JAIL					
00-2-1100	DATA PROCESSING COSTS	274.11	AT&T MOBILITY	PHONE SVC BCSO 287298012011	02406242
00-2-1100	DATA PROCESSING COSTS	576.00	DAS STATE ACCTNG-CENTRAL	DAS BCSO 1428085	02406300
00-2-1810	UNIFORM CLEANING/PURCHASE	848.87	GALLS, LLC	EQUIP BCSO 27937931 2794001	02406341
00-2-1900	BOARD OF PRISONERS	32,922.65	SUMMIT FOOD SERVICE, LLC	FOOD SVC BCJ INV2000208128	02406479
00-2-2901	LAW ENFORCEMENT COSTS - COUNTY	243.00	INTERSTATE ALL BATTERY CE	SUPPLIES BCSO 1905899024687	02406365
00-2-2901	LAW ENFORCEMENT COSTS - COUNTY	54.53	SHREDDING SOLUTIONS	SVC BCJ 18886	02406468
00-2-2901	LAW ENFORCEMENT COSTS - COUNTY	69.72	WELLS FARGO BANKS ACCT AN	FEEES BCJ 24040001911	02406502
00-2-2901	LAW ENFORCEMENT COSTS - COUNTY	17.18	WELLS FARGO	EXPENSES CC 3346	02406505
00-2-2912	SHERIFF'S TRAINING SCHOOL	398.95	CONSOLIDATED MANAGEMENT C	FOOD SVC BCSO 2401791 24019	02406290
00-2-3000	6 MED & HOSP CLIENT SERVICE	15,837.42	ADVANCED CORRECTIONAL HEA	MEDICAL BCJ RINV001235	02406229
00-2-3000	6 MED & HOSP CLIENT SERVICE	142.63	BRYAN HEALTH	MEDICAL BCJ 100345482	02406254
00-2-3000	6 MED & HOSP CLIENT SERVICE	13,576.18	CHI HEALTH GOOD SAMARITAN	MEDICAL BCJ 450868386	02406276
00-2-3000	6 MED & HOSP CLIENT SERVICE	229.57	CHI HEALTH CLINIC SPECIAL	MEDICAL BCJ P305387380 P305	02406277
00-2-3000	6 MED & HOSP CLIENT SERVICE	5.91	CONTEMPORARY OBSTETRICS	MEDICAL BCJ 98361V20449	02406292
00-2-3000	6 MED & HOSP CLIENT SERVICE	13,025.08	DIAMOND DRUGS, INC	MEDICAL BCJ IN001413816 INO	02406310
00-2-3000	6 MED & HOSP CLIENT SERVICE	96.59	DJO, LLC	MEDICAL BCJ D8700151	02406312
00-2-3000	6 MED & HOSP CLIENT SERVICE	200.55	FIRST CARE MEDICAL PC	MEDICAL BCJ 257615	02406336
00-2-3000	6 MED & HOSP CLIENT SERVICE	71.50	GARCIA CLINICAL LABORATOR	MEDICAL BCJ 69006	02406342
00-2-3000	6 MED & HOSP CLIENT SERVICE	1,023.00	HEARTLAND ORAL SURGERY	MEDICAL BCJ 508810	02406352
00-2-3000	6 MED & HOSP CLIENT SERVICE	427.68	IHS PHARMACY	MEDICAL BCJ 103149	02406361
00-2-3000	6 MED & HOSP CLIENT SERVICE	280.00	KEARNEY EYE INSTITUTE	MEDICAL BCJ 1019369	02406374
00-2-3000	6 MED & HOSP CLIENT SERVICE	660.00	PLATTE VALLEY DENTAL CLIN	MEDICAL BCJ 614657	02406450
00-2-3000	6 MED & HOSP CLIENT SERVICE	800.00	RETINA CENTER OF NEBRASKA	MEDICAL BCJ 91531	02406458
00-2-3100	PROVISIONS & CLOTHING	612.01	MCKESSON MEDICAL SURGICAL	MEDICAL BCJ 22170109 221994	02406402
00-2-3100	PROVISIONS & CLOTHING	269.54	WELLS FARGO	SUPPLIES BCJ 3465	02406506

BUFFALO
BOARD PREAPPROVAL REPORT
COUNTY GENERAL
FROM 06/25/2024 TO 06/27/2024

Account #	Description	Account Amt	Vendor	Invoice Description	Claim #

	671-00 COUNTY JAIL	82,662.67			

693-00	EMERGENCY MANAGER				
00-2-0200	TELEPHONE SERVICE	174.92	AT&T MOBILITY	PHONE SVC BSCO 287298012011	02406242
00-2-0200	TELEPHONE SERVICE	1,324.51	U.S. BANK	EXPENSES BOARD 4485: 594555	02406492
00-2-1200	OFFICE EQUIPMENT REPAIRS	53.25	PLATTE VALLEY COMMUNICATI	EQUIP COMMUNICATIONS 062400	02406449
00-2-1801	DUES, SUBSCRIPTIONS, REGISTRAT	200.00	BUFFALO COUNTY	DUES EM 2024-2025	02406258
00-2-2000	PRINTING AND PUBLISHING	138.22	COPYCAT PRINTING CENTER	PUBLISHING EM 213178	02406293
00-3-0101	OFFICE SUPPLIES	222.00	QUILL CORPORATION	SUPPLIES BCSO 38550671 EM 3	02406453
00-3-0209	MACHINERY & EQUIP - FUEL	150.39	CITY OF KEARNEY	FUEL BCSO 2024: 00000081 EM	02406281
00-3-0210	MACHINERY & EQUIP - GREASE/OIL	478.18	U.S. BANK	EXPENSES BOARD 4485: 594555	02406492
00-3-0211	MACHINERY & EQUIP - TIRES/REPA	124.99	NAPA AUTO PARTS	PARTS BCSO 757545 757549 75	02406421
00-5-1309	DATA PROCESSING SOFTWARE	1,000.00	U.S. BANK	EXPENSES BOARD 4485: 594555	02406492

	693-00 EMERGENCY MANAGER	3,866.46			

702-00	SURVEYOR				
00-4-0200	1 EQUIPMENT RENTAL	1,000.00	TRENTON SNOW, LLC	RENTAL SURVEYOR	02406471

	702-00 SURVEYOR	1,000.00			

801-00	EMERGENCY RELIEF				
00-2-3200	1 RENT & FUEL CLIENT SERVICE	290.00	DOMINION REAL ESTATE KEAR	RENT S THALKEN	02406314
00-2-3200	RENT & FUEL CLIENT SERVICE	210.00	ELN, LLC	RENT A SANDOVAL M STOPPKOTT	02406326
00-2-3200	1 RENT & FUEL CLIENT SERVICE	330.00	ELN, LLC	RENT A SANDOVAL M STOPPKOTT	02406326
00-2-3200	1 RENT & FUEL CLIENT SERVICE	290.00	KEARNEY HOUSING AGENCY	RENT M ADAMS	02406375
00-2-3200	RENT & FUEL CLIENT SERVICE	537.99	NEBRASKA PUBLIC POWER DIS	UTILITIES K DETLER L PACHECO	02406427
00-2-3200	1 RENT & FUEL CLIENT SERVICE	210.00	GREG TREJO	RENT D KOENIG	02406487
00-2-3400	COUNTY BURIALS	3,000.00	HORNER, LIESKE, MCBRIDE &	CREMATION D GOULD W MERRILL	02406357
00-2-3400	COUNTY BURIALS	1,500.00	O'BRIEN STRAATMANN REDING	CREMATION J STENGEL	02406437

	801-00 EMERGENCY RELIEF	6,367.99			

803-00	VETERAN'S SERVICE OFFICE				
00-2-1702	LODGING	171.32	MATTHEW STARKEY	REIMBURSE MILEAGE MILEAGE M	02406475
00-2-1702	LODGING	250.00	U.S. BANK	EXPENSES BOARD 4485: 594555	02406492
00-2-1704	MILEAGE	14.74	SUSAN A JANSSEN	REIMBURSE MILEAGE	02406368
00-2-1704	MILEAGE	21.04	LINDA JONES	REIMBURSE MILEAGE	02406370
00-2-1704	MILEAGE	245.49	MATTHEW STARKEY	REIMBURSE MILEAGE MILEAGE M	02406475
00-2-1800	OTHER (COMMITTEE EXPENSE)	11.28	LINCOLN JOURNAL STAR	PUBLISHING ELECTIONS 121775	02406387
00-3-0101	OFFICE SUPPLIES	130.19	AMAZON CAPITAL SERVICES	EXPENSES ASSESSOR 11281876	02406233

BUFFALO
BOARD PREAPPROVAL REPORT
COUNTY GENERAL
FROM 06/25/2024 TO 06/27/2024

Account #	Description	Account Amt	Vendor	Invoice Description	Claim #

	803-00 VETERAN'S SERVICE OFFICE	844.06			

822-00	INSTITUTIONS				
00-2-2801	NORFOLK REGIONAL CENTER	279.00	NEBRASKA HEALTH & HUMAN S	PT SVCS BOARD NORFOLK BEATR	02406425
00-2-2802	BEATRICE REGIONAL CENTER	144.00	NEBRASKA HEALTH & HUMAN S	PT SVCS BOARD NORFOLK BEATR	02406425
00-2-2805	LINCOLN REGIONAL CENTER	1,089.25	NEBRASKA HEALTH & HUMAN S	PT SVCS BOARD NORFOLK BEATR	02406425

	822-00 INSTITUTIONS	1,512.25			

970-00	MISCELLANEOUS GENERAL				
00-1-0806	TPA ADMINISTRATION FEES	1,859.55	COMPSYCH CORPORATION	FEES BOARD 7/1-9/30/2024	02406289
00-2-0100	POSTAL SERVICE	16,977.44	MIDWEST CONNECT, LLC	POSTAGE EXT OFFICE BC05 5/1	02406409
00-2-0100	POSTAL SERVICE	214.53	QUADIENT LEASING USA, INC	LEASE BOARD Q1342879	02406452
00-2-0601	GENERAL LIABILITY INSURANCE	537,912.00	NIRMA	SVC BOARD INV 25 9	02406432
00-2-0602	AUTO PHYSICAL DAMAGE INSURANCE	821.09	DENT POPPER, INC	SVC BCSO 2024 12 DELQ TAXES	02406307
00-2-0602	AUTO PHYSICAL DAMAGE INSURANCE	1,000.00	EUSTIS BODY SHOP	TOWING BCSO 7Y4XVYH	02406329
00-2-0602	AUTO PHYSICAL DAMAGE INSURANCE	1,000.00	PLATTE VALLEY AUTO	REPAIR BCSO 60556121	02406448
00-2-0602	AUTO PHYSICAL DAMAGE INSURANCE	115.66	BUFFALO COUNTY TREASURER	DELINQUENT TAX DENT POPPER	02406599
00-2-1100	DATA PROCESSING COST (CO LOCAT	139,481.25	CITY OF KEARNEY	FUEL BCSO 2024: 00000081 EM	02406281
00-2-1105	GPS COSTS	770.95	VERIZON	TRACKERS BOARD 318000005914	02406496
00-2-1601	VEHICLE REPAIRS	2,200.80	ATS	SVC BCSO 66607 66662 66718	02406243
00-2-1706	7 PARKING/TOLLS (TOWING)	131.00	DONKEY TOWING & TRANSFER	TOWING BCSO 052724	02406316
00-2-1706	7 PARKING/TOLLS (TOWING)	173.60	DOWHY TOWING & RECOVERY	TOWING BCSO 2406136205	02406318
00-2-1706	PARKING/TOLLS (TOWING)	125.00	TURNER BODY SHOP OF KEARN	TOWING BCSO 28825	02406488
00-2-1856	SCPET (FISCAL AGENT)	3,101.40	AMAZON CAPITAL SERVICES	EXPENSES ASSESSSOR 11281876	02406233
00-2-1856	SCPET (FISCAL AGENT)	1,259.26	ARCHANGEL DEVICE LLC	EQUIP BOARD WC116486	02406236
00-2-1856	SCPET (FISCAL AGENT)	3,250.00	ARMSTRONG MEDICAL	EQUIP BOARD 2112180	02406240
00-2-1856	SCPET (FISCAL AGENT)	8,500.00	CENTRAL NEBRASKA RESERVE	EQUIP BOARD GRANT112774862	02406271
00-2-1856	7 SCPET (FISCAL AGENT)	152.50	IDEABANK MARKETING	SVC BOARD 16280	02406359
00-2-1856	SCPET (FISCAL AGENT)	1,419.00	REGION 51 EMERGENCY MANAG	SUPPLIES BOARD 114: 3729692	02406457
00-2-1856	SCPET (FISCAL AGENT)	13,032.37	U.S. BANK	EXPENSES BOARD 4485: 594555	02406492
00-2-1901	BOARDING CONTRACTS	302.75	DEPARTMENT OF CORRECTIONA	SVC BCSO 1430055	02406308
00-2-2010	JUVENILE DETENTION	6,938.75	NORTHEAST NEBRASKA JUVENI	SVC BOARD 018667	02406435
00-2-2414	JUVENILE JUSTICE	3,757.82	BOYS TOWN	SVC CO ATTORNEY GRANT24CB05	02406250
00-2-2414	JUVENILE JUSTICE	1,266.79	BUFFALO COUNTY COMMUNITY	SVC CO ATTORNEY GRANT24CB05	02406257
00-2-2414	JUVENILE JUSTICE	500.00	CENTRAL MEDIATION CENTER	SVC CO ATTORNEY GRANT24CB05	02406270
00-2-2414	6 JUVENILE JUSTICE	1,592.50	COMPASS FAMILY SUPPORT SE	SVC CO ATTORNEY GRANT24CB50	02406288
00-2-2414	JUVENILE JUSTICE	5,638.60	FATHER FLANAGAN'S BOYS'HO	SVC CO ATTORNEY GRANT24JS04	02406334
00-2-2416	DRUG PROGRAM COSTS (MULTI JUR	953.45	ADVANTAGE POLICE SUPPLY	SUPPLIES BCSO 240367	02406230
00-2-2416	DRUG PROGRAM COSTS (MULTI JUR	2,102.05	AT&T MOBILITY	PHONE SVC BCSO 287298012011	02406242
00-2-2416	DRUG PROGRAM COSTS (MULTI JUR	775.00	HALL WEAPON SYSTEMS	EQUIP BCSO 06042024	02406349
00-2-2416	DRUG PROGRAM COSTS (MULTI JUR	6,314.58	WELLS FARGO	EXPENSES BCSO CC 8950	02406503
00-2-2450	DRUG ENFORCEMENT (HS)	288.71	ADVANTAGE POLICE SUPPLY	SUPPLIES BCSO 240367	02406230
00-2-2450	DRUG ENFORCEMENT (HS)	82.97	DANA SAFETY SUPPLY, INC	EQUIP BCSO 202408	02406297
00-2-2450	DRUG ENFORCEMENT (HS)	8,423.74	MALLORY SAFETY & SUPPLY L	EQUIP BCSO 5918092 3563935	02406394

BUFFALO
BOARD PREAPPROVAL REPORT
COUNTY GENERAL
FROM 06/25/2024 TO 06/27/2024

Account #	Description	Account Amt	Vendor	Invoice Description	Claim #
00-2-2450	DRUG ENFORCEMENT (HS)	8,983.58	MOTOROLA SOLUTIONS, INC.	EQUIP BCSO 1187122633 82304	02406420
00-2-2450	DRUG ENFORCEMENT (HS)	7,221.00	SUNSET LAW ENFORCEMENT	EQUIP BCSO 0010456	02406480
00-2-2500	7 CONSULTING FEE	75.00	WOODS & AITKEN LLP	CONSULT BOARD 98081197	02406513
00-2-2515	CONTRACTUAL SERVICE (FAN REIMB	2,000.00	FAMILY ADVOCACY NETWORK	FEE BCSO 2024 CO ATTORNEY 2	02406330
00-2-2557	ADULT INMATE TRANSPORTATION CO	2,199.90	MIDWEST SPECIAL SERVICES,	TRANSPORT BCSO 411183	02406411
00-2-2600	9 COURT COSTS	10,690.35	BRUNER FRANK SCHUMACHER,	LEGAL DIST COURT 111828 111	02406253
00-2-2600	6 COURT COSTS	650.00	BRYCE RIESSLAND	LEGAL DIST COURT CR24 184 C	02406255
00-2-2600	COURT COSTS	30.00	BUFFALO COUNTY ATTORNEY	SUPPLIES PUB DEFENDER CR23	02406259
00-2-2600	COURT COSTS	462.53	BUFFALO COUNTY ATTORNEY'S	EXPENSES CO ATTORNEY 5483 5	02406260
00-2-2600	COURT COSTS	2,937.02	BUFFALO COUNTY COURT	FEEES CO COURT 575 576	02406262
00-2-2600	COURT COSTS	2,146.00	CLERK OF THE DISTRICT COU	LEGAL DIST COURT 599 600	02406283
00-2-2600	9 COURT COSTS	883.33	COCHRAN LAW PC, LLO	LEGAL DIST COURT 2024 0462	02406285
00-2-2600	9 COURT COSTS	700.00	BRANDON DUGAN LAW	LEGAL DIST COURT 2213 2212	02406319
00-2-2600	9 COURT COSTS	3,689.96	FYE LAW OFFICE	LEGAL DIST COURT 10271 1027	02406340
00-2-2600	COURT COSTS	125.30	GENERAL REPORTING SERVICE	TRANSCRIPT CO COURT CR23 56	02406344
00-2-2600	9 COURT COSTS	3,383.05	JACOBSEN ORR LAW FIRM	LEGAL DIST COURT CI19 155 C	02406367
00-2-2600	9 COURT COSTS	6,942.00	KLEIN BREWSTER BRANDT & M	LEGAL DIST COURT 6196 6198	02406380
00-2-2600	COURT COSTS	6.00	LANCASTER COUNTY SHERIFF	FEE CO COURT JV24 52	02406384
00-2-2600	9 COURT COSTS	467.50	LIESKE, LIESKE & ENSZ, PC	LEGAL DIST COURT CR24 4 CR2	02406388
00-2-2600	COURT COSTS	16.50	LINCOLN COUNTY SHERIFF	FEE CO COURT CR24 695	02406389
00-2-2600	7 COURT COSTS	1,059.50	JENNIFER R MCCARTER REPOR	TRANSCRIPT DIST COURT CR22	02406401
00-2-2600	COURT COSTS	51.00	NEBRASKA INTERACTIVE LLC	SVC CO ATTORNEY 8397970	02406429
00-2-2600	9 COURT COSTS	291.28	PARKER GROSSART BAHENSKY	LEGAL DIST COURT CI13 122 C	02406441
00-2-2600	6 COURT COSTS	8,300.00	PHYSICIANS LABORATORY P.C	MEDICAL CO ATTORNEY 5989598	02406444
00-2-2600	COURT COSTS	41.00	SARPY COUNTY SHERIFF'S OF	FEE CO COURT 2024: 004436 0	02406463
00-2-2600	9 COURT COSTS	2,088.00	STAMM ROMERO & ASSOC, P.C	LEGAL DIST COURT 4222 48264	02406474
00-2-2600	9 COURT COSTS	815.18	THOMAS S STEWART	LEGAL DIST COURT 5840 582?	02406478
00-2-2600	9 COURT COSTS	1,023.99	MICHAEL J SYNEK	LEGAL DIST COURT CI24 77 CI	02406481
00-2-2600	9 COURT COSTS	160.00	TYE & ROWLING, PC, LLO	LEGAL DIST COURT 25712 2571	02406490
00-2-2600	6 COURT COSTS	986.67	JERRY A. VAN WINKLE, PSYD	MEDICAL DIST COURT CR24 178	02406495
00-2-2917	DARE	5,000.00	DANA SAFETY SUPPLY, INC	EQUIP BCSO 202408	02406297
00-2-2918	CANDO	3,437.62	DANA SAFETY SUPPLY, INC	EQUIP BCSO 202408	02406297
00-2-2918	CANDO	1,090.64	WELLS FARGO	EXPENSES BCSO CC 8950	02406503
00-2-2918	CANDO	3,471.74	WELLS FARGO	EXPENSES CC 3346	02406505
00-2-3030	DRUG TESTING	275.00	WPCI	SCREENING COMMUNICATIONS MA	02406514
00-2-4000	HAZMAT TEAM	80.08	AT&T MOBILITY	PHONE SVC BSCO 287298012011	02406242
00-2-4411	AREA AGENCY ON AGING (&SENIOR	2,500.00	CITY OF KEARNEY	FUEL BCSO 2024: 00000081 EM	02406281
00-2-4420	MENTAL HEALTH SERVICE (REGION	9,416.00	REGION III BEHAVIORAL HEA	EXPENSES BCSO 13194	02406456
00-2-4429	BOOKMOBILE	23,869.92	CITY OF KEARNEY	FUEL BCSO 2024: 00000081 EM	02406281
00-2-4430	PARKS & RECREATION	28,922.59	CITY OF KEARNEY	FUEL BCSO 2024: 00000081 EM	02406281
00-2-8900	AUTOPSY COSTS	400.00	HORNER, LIESKE, MCBRIDE &	CREMATION D GOULD W MERRILL	02406357
00-2-9900	MISCELLANEOUS	31.20	MIRROR IMAGE CAR WASH	SERVICES BSCO 1891049 BOARD	02406413
00-2-9900	7 MISCELLANEOUS	55.00	PAPER TIGER SHREDDING, IN	SVC BOARD 199782	02406440
00-2-9900	MISCELLANEOUS	3,812.46	U.S. BANK	EXPENSES BOARD 4485: 594555	02406492
00-3-0209	MACHINERY & EQUIPMENT FUEL	62,167.84	CITY OF KEARNEY	FUEL BCSO 2024: 00000081 EM	02406281
00-3-0400	MISCELLANEOUS (PRISONER MISC)	174.50	CHARM-TEX INC	SUPPLIES BCSO 845537	02406273
00-3-0400	MISCELLANEOUS (PRISONER MISC)	7.65	CHARTER COMMUNICATIONS	PHONE SVC COMMUNICATIONS 17	02406274
00-3-0400	MISCELLANEOUS (PRISONER MISC)	385.00	GUARDIAN RFID	SUPPLIES BCSO 10880	02406348
00-3-0400	MISCELLANEOUS (PRISONER MISC)	50,000.00	MOTOROLA SOLUTIONS, INC	EQUIP BOARD 2024 0607	02406419
00-4-0500	1 BUILDING/FACILITY RENTAL	4,957.36	HAND FARMS LLP	RENT BOARD	02406350

BUFFALO
BOARD PREAPPROVAL REPORT
COUNTY GENERAL
FROM 06/25/2024 TO 06/27/2024

Account #	Description	Account Amt	Vendor	Invoice Description	Claim #
00-4-0501	OFFICE SPACE RENT (CO-LOCATION	22,282.98	CITY OF KEARNEY	FUEL BCSO 2024: 00000081 EM	02406281
00-5-0315	DATA PROCESS EQUIP (MOB DATA T	12,438.74	WELLS FARGO	EXPENSES BCSO CC 8950	02406503
970-00 MISCELLANEOUS GENERAL		1,075,637.07			
0100 COUNTY GENERAL FUND		2,449,432.02			
705-00 ROAD FUND					
00-2-1200	OFFICE EQUIPMENT REPAIR	212.00	FARMERS CO-OP ASSOCIATION	FUEL ROAD 994804 999194 100	02406537
00-2-1400	ROAD EQUIPMENT REPAIR-PARTS	72.36	AMAZON CAPITAL SERVICES	REPAIRS ROAD 1PVJ94LLKLN9 1	02406520
00-2-1400	ROAD EQUIPMENT REPAIR-PARTS	2,221.47	ARNOLD MOTOR SUPPLY/AUTO	REPAIRS ROAD 76NV169372 76N	02406522
00-2-1400	ROAD EQUIPMENT REPAIR-PARTS	684.97	CUMMINS SALES AND SERVICE	REPAIRS ROAD J760543	02406532
00-2-1400	ROAD EQUIPMENT REPAIR-PARTS	350.00	DENT POPPER, INC	REPAIRS ROAD 356248 356249	02406533
00-2-1400	ROAD EQUIPMENT REPAIR-PARTS	1,012.11	FARM PLAN	REPAIRS ROAD 11691523 11694	02406536
00-2-1400	ROAD EQUIPMENT REPAIR-PARTS	562.37	GLASS DOCTOR OF CENTRAL N	REPAIRS ROAD 120364 120365	02406540
00-2-1400	ROAD EQUIPMENT REPAIR-PARTS	65.99	GRAHAM TIRE CO	SUPPLIES ROAD 1313346033 13	02406541
00-2-1400	ROAD EQUIPMENT REPAIR-PARTS	474.50	KEARNEY TRAILERS LLC	REPAIRS ROAD 000658 000665	02406545
00-2-1400	ROAD EQUIPMENT REPAIR-PARTS	122.84	KELLY SUPPLY COMPANY	REPAIRS ROAD S200647180	02406546
00-2-1400	ROAD EQUIPMENT REPAIR-PARTS	2.60	KIMBALL MIDWEST	SUPPLIES ROAD 102271795 102	02406547
00-2-1400	ROAD EQUIPMENT REPAIR-PARTS	1,717.85	MAINTAINER CORPORATION OF	REPAIRS ROAD 039264	02406549
00-2-1400	ROAD EQUIPMENT REPAIR-PARTS	131.28	MATHESON TRI-GAS INC	PARTS ROAD 0029691904 00297	02406551
00-2-1400	ROAD EQUIPMENT REPAIR-PARTS	79.89	NEBRASKA TRUCK CENTER INC	REPAIRS ROAD NTCRO: 399477	02406559
00-2-1400	ROAD EQUIPMENT REPAIR-PARTS	3,802.10	NMC, INC.	EQUIP ROAD QTO0893505 REPAI	02406560
00-2-1400	ROAD EQUIPMENT REPAIR-PARTS	2,859.61	POWERPLAN-MURPHY TRACTOR	REPAIRS 2236767 2244819 224	02406562
00-2-1400	ROAD EQUIPMENT REPAIR-PARTS	6,468.83	SAHLING KENWORTH INC	REPAIRS ROAD 041P363720 041	02406563
00-2-1400	ROAD EQUIPMENT REPAIR-PARTS	2,699.72	TRUCK CENTER COMPANIES	REPAIRS ROAD XA10507: 05280	02406568
00-2-1400	ROAD EQUIPMENT REPAIR-PARTS	3,192.00	U.S. BANK	EXPENSES ROAD CC	02406569
00-2-1400	ROAD EQUIPMENT REPAIR-PARTS	4.50	WILKE'S TRUE VALUE	SUPPLIES ROAD 2406 088018 2	02406571
00-2-1500	ROAD EQUIPMENT REPAIR-LABOR	1,100.00	DENT POPPER, INC	REPAIRS ROAD 356248 356249	02406533
00-2-1500	ROAD EQUIPMENT REPAIR-LABOR	350.00	GLASS DOCTOR OF CENTRAL N	REPAIRS ROAD 120364 120365	02406540
00-2-1500	ROAD EQUIPMENT REPAIR-LABOR	24.00	GRAHAM TIRE CO	SUPPLIES ROAD 1313346033 13	02406541
00-2-1500	ROAD EQUIPMENT REPAIR-LABOR	590.00	MARLATT PRECISION LLC	SUPPLIES ROAD 2859	02406550
00-2-1500	ROAD EQUIPMENT REPAIR-LABOR	1,454.85	NEBRASKA TRUCK CENTER INC	REPAIRS ROAD NTCRO: 399477	02406559
00-2-1500	ROAD EQUIPMENT REPAIR-LABOR	3,180.00	NMC, INC.	EQUIP ROAD QTO0893505 REPAI	02406560
00-2-1500	ROAD EQUIPMENT REPAIR-LABOR	935.00	TRUCK CENTER COMPANIES	REPAIRS ROAD XA10507: 05280	02406568
00-2-1501	CAR REPAIR LABOR (ROAD EQP RP	120.00	GLASS DOCTOR OF CENTRAL N	REPAIRS ROAD 120364 120365	02406540
00-2-1600	OTHER EQUIPMENT REPAIR	87.55	AMAZON CAPITAL SERVICES	REPAIRS ROAD 1PVJ94LLKLN9 1	02406520
00-2-1600	OTHER EQUIPMENT REPAIR	6.00	CONSTRUCTION RENTAL INC	REPAIRS ROAD 4887992 489068	02406530
00-2-1600	OTHER EQUIPMENT REPAIR	106.71	MENARDS - KEARNEY	REPAIRS ROAD 73456 73004 73	02406553
00-2-1702	LODGING	214.00	HARMONY INN & SUITES	LODGING ROAD 40333643	02406542
00-2-1805	PERSONAL SAFETY EQUIPMENT	88.45	ARNOLD MOTOR SUPPLY/AUTO	REPAIRS ROAD 76NV169372 76N	02406522
00-2-1805	PERSONAL SAFETY EQUIPMENT	529.52	KIMBALL MIDWEST	SUPPLIES ROAD 102271795 102	02406547
00-2-2200	EXPRESS & FREIGHT	300.00	LOGAN CONTRACTORS SUPPLY	ASPHALT ROAD D92568	02406548
00-2-2200	EXPRESS & FREIGHT	21.91	MAINTAINER CORPORATION OF	REPAIRS ROAD 039264	02406549
00-2-2200	EXPRESS & FREIGHT	174.83	NMC, INC.	EQUIP ROAD QTO0893505 REPAI	02406560

BUFFALO
BOARD PREAPPROVAL REPORT
COUNTY ROAD
FROM 06/25/2024 TO 06/27/2024

Account #	Description	Account Amt	Vendor	Invoice Description	Claim #
00-2-2200	EXPRESS & FREIGHT	60.40	SPEEDTECH LIGHTS INC	SUPPLIES ROAD 385895	02406565
00-2-2200	EXPRESS & FREIGHT	75.00	TRUCK CENTER COMPANIES	REPAIRS ROAD XA10507: 05280	02406568
00-2-2200	EXPRESS & FREIGHT	285.95	U.S. BANK	EXPENSES ROAD CC	02406569
00-2-2200	EXPRESS & FREIGHT	19.85	WINZER	GRAVEL ROAD 2120371 2160346	02406572
00-3-0101	OFFICE SUPPLIES	570.53	EAKES OFFICE SOLUTIONS	SUPPLIES ROAD 89497840 8949	02406534
00-3-0106	SHOP SUPPLIES	320.16	ARNOLD MOTOR SUPPLY/AUTO	REPAIRS ROAD 76NV169372 76N	02406522
00-3-0106	SHOP SUPPLIES	81.80	CORNHUSKER CLEANING SUPPL	SUPPLIES ROAD 401684	02406531
00-3-0106	SHOP SUPPLIES	98.38	KIMBALL MIDWEST	SUPPLIES ROAD 102271795 102	02406547
00-3-0106	SHOP SUPPLIES	315.67	MATHESON TRI-GAS INC	PARTS ROAD 0029691904 00297	02406551
00-3-0106	SHOP SUPPLIES	116.39	NEBRASKA TRUCK CENTER INC	REPAIRS ROAD NTCRO: 399477	02406559
00-3-0106	SHOP SUPPLIES	140.25	TRUCK CENTER COMPANIES	REPAIRS ROAD XA10507: 05280	02406568
00-3-0106	SHOP SUPPLIES	599.60	WINZER	GRAVEL ROAD 2120371 2160346	02406572
00-3-0110	SMALL TOOLS	275.00	AMAZON CAPITAL SERVICES	REPAIRS ROAD 1PVJ94LLKNL9 1	02406520
00-3-0110	SMALL TOOLS	125.53	ARNOLD MOTOR SUPPLY/AUTO	REPAIRS ROAD 76NV169372 76N	02406522
00-3-0110	SMALL TOOLS	199.00	BUILDERS WAREHOUSE INC	SUPPLIES ROAD 1633774	02406524
00-3-0110	SMALL TOOLS	2,266.88	CENTRAL AG AND SHOP SUPPL	SUPPLIES ROAD 5.19.24 5.29.	02406525
00-3-0110	SMALL TOOLS	51.52	FARM PLAN	REPAIRS ROAD 11691523 11694	02406536
00-3-0110	SMALL TOOLS	1,381.95	FASTENAL COMPANY	SUPPLIES ROAD NEKEA206408	02406538
00-3-0110	SMALL TOOLS	305.57	KIMBALL MIDWEST	SUPPLIES ROAD 102271795 102	02406547
00-3-0110	SMALL TOOLS	25.98	MENARDS - KEARNEY	REPAIRS ROAD 73456 73004 73	02406553
00-3-0110	SMALL TOOLS	830.45	U.S. BANK	EXPENSES ROAD CC	02406569
00-3-0201	ASPHALTIC	11,812.50	LOGAN CONTRACTORS SUPPLY	ASPHALT ROAD D92568	02406548
00-3-0202	GRAVEL AND BORROW	40,000.00	ED BROADFOOT & SONS SAND	GRAVEL ROAD 44808	02406535
00-3-0202	GRAVEL AND BORROW	30,902.86	MID NEBRASKA AGGREGATE IN	GRAVEL ROAD 240672	02406555
00-3-0202	7 GRAVEL AND BORROW	26,325.00	NSG LOGISTICS, LLC	GRAVEL ROAD SO00000238	02406558
00-3-0202	GRAVEL AND BORROW	4,448.81	SOUTHWEST GRAVEL PRODUCTS	GRAVEL ROAD BC2024 10 BC202	02406564
00-3-0202	GRAVEL AND BORROW	14,844.50	WINZER	GRAVEL ROAD 2120371 2160346	02406572
00-3-0203	GRADER BLADES	702.49	FARM PLAN	REPAIRS ROAD 11691523 11694	02406536
00-3-0203	GRADER BLADES	35,976.00	MICHAEL TODD & COMPANY IN	SUPPLIES ROAD 68425	02406554
00-3-0203	GRADER BLADES	1,160.00	MIDWEST SERVICE & SALES C	SUPPLIES ROAD 0035601 00356	02406556
00-3-0205	7 CONCRETE, ETC.	137,873.27	THEISEN CONSTRUCTION, INC	CONCRETE ROAD C001016945	02406566
00-3-0205	7 CONCRETE, ETC.	64,408.35	THEISEN CONSTRUCTION, INC	CONCRETE ROAD C001016945	02406567
00-3-0205	CONCRETE, ETC.	50,680.64	WILKE CONTRACTING CORP	CONCRETE ROAD APPLICATION 6	02406570
00-3-0206	CULVERTS	77,610.97	ACE IRRIGATION & MFG CO	SUPPLIES ROAD 113012 113017	02406519
00-3-0207	STEEL PRODUCTS	50.77	JACK LEDERMAN CO, INC	SUPPLIES ROAD 106426	02406544
00-3-0207	STEEL PRODUCTS	24.79	MARLATI PRECISION LLC	SUPPLIES ROAD 2859	02406550
00-3-0209	MACHINERY & EQUIPMENT FUEL	61.11	CHS INC	FUEL ROAD HS8 IJ7334	02406527
00-3-0209	MACHINERY & EQUIPMENT FUEL	64.04	CFP-C-T	FUEL ROAD 1010611	02406528
00-3-0209	MACHINERY & EQUIPMENT FUEL	10.00	COMFY BOWL, INC	RENT ROAD 88605	02406529
00-3-0209	MACHINERY & EQUIPMENT FUEL	25.50	MATHESON TRI-GAS INC	PARTS ROAD 0029691904 00297	02406551
00-3-0209	MACHINERY & EQUIPMENT FUEL	149.85	U.S. BANK	EXPENSES ROAD CC	02406569
00-3-0210	MACHINERY & EQUIPMENT GREASE O	66.04	ARNOLD MOTOR SUPPLY/AUTO	REPAIRS ROAD 76NV169372 76N	02406522
00-3-0210	MACHINERY & EQUIPMENT GREASE O	545.27	FARM PLAN	REPAIRS ROAD 11691523 11694	02406536
00-3-0210	MACHINERY & EQUIPMENT GREASE O	208.93	TRUCK CENTER COMPANIES	REPAIRS ROAD XA10507: 05280	02406568
00-3-0210	MACHINERY & EQUIPMENT GREASE O	29.97	WILKE'S TRUE VALUE	SUPPLIES ROAD 2406 088018 2	02406571
00-3-0211	MACHINERY EQUIPMENT TIRE REP	10.00	BUFFALO COUNTY TREASURER	TITLE ROAD	02406523
00-3-0211	MACHINERY EQUIPMENT TIRE REP	46,280.26	GARRETT TIRES & TREADS -	REPAIRS ROAD 2157290 215729	02406539
00-3-0211	MACHINERY EQUIPMENT TIRE REP	1,005.23	GRAHAM TIRE CO	SUPPLIES ROAD 1313346033 13	02406541
00-3-0211	MACHINERY EQUIPMENT TIRE REP	20.00	U.S. BANK	EXPENSES ROAD CC	02406569
00-3-0213	EROSION CONTROL	3,150.00	ARROW SEED CO INC	SUPPLIES ROAD OP76995JW	02406521

BUFFALO
BOARD PREAPPROVAL REPORT
COUNTY ROAD
FROM 06/25/2024 TO 06/27/2024

Account #	Description	Account Amt	Vendor	Invoice Description	Claim #
00-3-0301	SIGNS	400.00	MIDWEST SERVICE & SALES C	SUPPLIES ROAD 0035601 00356	02406556
00-3-0308	FLARES, FLAGS & BARRICADE	10.84	ARNOLD MOTOR SUPPLY/AUTO	REPAIRS ROAD 76NV169372 76N	02406522
00-3-0308	FLARES, FLAGS & BARRICADE	37.92	MENARDS - KEARNEY	REPAIRS ROAD 73456 73004 73	02406553
00-3-0308	FLARES, FLAGS & BARRICADE	1,449.91	SPEEDTECH LIGHTS INC	SUPPLIES ROAD 385895	02406565
00-4-0100	EQUIPMENT RENTAL ROAD	2,418.00	WAM, INC	RENT ROAD CNB1428	02406526
00-4-0100	EQUIPMENT RENTAL ROAD	95.00	COMFY BOWL, INC	RENT ROAD 88605	02406529
00-5-0303	TRUCKS	95,798.00	HUSKER AUTO GROUP	VEHICLE ROADS 21202336 2120	02406543
00-5-0307	MOTOR GRADERS	378,990.00	MURPHY TRACTOR AND EQUIPM	EQUIP ROAD 10413216 1045130	02406557
00-5-0307	MOTOR GRADERS	381,000.00	NMC, INC.	EQUIP ROAD QTO0893505 REPAI	02406560
00-5-1100	OTHER EQUIPMENT	334.60	CONSTRUCTION RENTAL INC	REPAIRS ROAD 4887992 489068	02406530
00-5-1100	OTHER EQUIPMENT	4,200.00	KEARNEY TRAILERS LLC	REPAIRS ROAD 000658 000665	02406545
00-5-1100	OTHER EQUIPMENT	9,528.36	MATHESON TRI-GAS INC	PARTS ROAD 0029691904 00297	02406551
00-5-1100	OTHER EQUIPMENT	2,624.00	MATT FRIEND TRUCK EQUIPME	EQUIP ROAD 0094211 0094223	02406552
00-5-1100	OTHER EQUIPMENT	8,400.00	MURPHY TRACTOR AND EQUIPM	EQUIP ROAD 10413216 1045130	02406557
00-5-1302	7 ENGINEERING FEES	6,967.95	OAK CREEK ENGINEERING, LL	ENGINEERING ROAD 24109 2410	02406561
00-5-2000	SPECIAL ASSESSMENT (TITLE/MISC	20.00	BUFFALO COUNTY TREASURER	TITLE ROAD	02406523
705-00 ROAD FUND		1,484,624.84			
0200 COUNTY ROAD FUND		1,484,624.84			
706-00 ROAD BUYBACK PROGRAM		454,768.53			
00-5-1211	7 BRIDGE PROJECTS	6,845.51	OAK CREEK ENGINEERING, LL	ENGINEERING ROAD BUYBACK 24	02406573
00-5-1211	BRIDGE PROJECTS	447,923.02	SIMON CONTRACTORS	BRIDGE ROAD BUYBACK APP 5	02406574
0650 HIGHWAY BRIDGE BUYBACK PROGRAM FUND		454,768.53			
879-00 COUNTY VISITORS PROMOTION					
00-1-0100	OFFICIALS SALARY	4,000.00	KEARNEY VISITOR'S BUREAU	EXPENSES MAY 2024	02406575
00-1-0201	CHIEF DEPUTY'S SALARY	4,000.00	KEARNEY VISITOR'S BUREAU	EXPENSES MAY 2024	02406575
00-1-0305	CLERICAL SALARY	4,000.00	KEARNEY VISITOR'S BUREAU	EXPENSES MAY 2024	02406575
00-1-0405	CLERICAL P/T SAL (CONVENTION R	3,000.00	KEARNEY VISITOR'S BUREAU	EXPENSES MAY 2024	02406575
00-1-1400	MISCELLANEOUS (PAYROLL TAXES)	4,000.00	KEARNEY VISITOR'S BUREAU	EXPENSES MAY 2024	02406575
00-2-0100	POSTAGE SERVICES	3,000.00	KEARNEY VISITOR'S BUREAU	EXPENSES MAY 2024	02406575
00-2-0200	TELEPHONE SERVICE	3,000.00	KEARNEY VISITOR'S BUREAU	EXPENSES MAY 2024	02406575
00-2-0601	GENERAL LIABILITY INSURANCE	3,000.00	KEARNEY VISITOR'S BUREAU	EXPENSES MAY 2024	02406575
00-2-1700	TRAVEL EXPENSES	301.00	KEARNEY VISITOR'S BUREAU	EXPENSES MAY 2024	02406575
00-2-1702	LODGING	1,000.00	KEARNEY VISITOR'S BUREAU	EXPENSES MAY 2024	02406575

BUFFALO
BOARD PREAPPROVAL REPORT
VISITOR'S PROMOTION
FROM 06/25/2024 TO 06/27/2024

Account # 1099	Description	Account Amt	Vendor	Invoice Description	Claim #
00-2-1704	MILEAGE ALLOWANCE	1,000.00	KEARNEY VISITOR'S BUREAU	EXPENSES MAY 2024	02406575
00-2-1801	DUES, SUB, REG & TRAINING	4,000.00	KEARNEY VISITOR'S BUREAU	EXPENSES MAY 2024	02406575
00-2-2000	PRINTING AND PUBLISHING	1,000.00	KEARNEY VISITOR'S BUREAU	EXPENSES MAY 2024	02406575
00-2-2001	PROMOTION ADVERTISING	50,000.00	KEARNEY VISITOR'S BUREAU	EXPENSES MAY 2024	02406575
00-3-0101	OFFICE SUPPLIES	1,000.00	KEARNEY VISITOR'S BUREAU	EXPENSES MAY 2024	02406575
00-3-0209	MACHINERY AND EQUIPMENT FUEL	1,000.00	KEARNEY VISITOR'S BUREAU	EXPENSES MAY 2024	02406575
00-3-0400	MISCELLANEOUS	1,000.00	KEARNEY VISITOR'S BUREAU	EXPENSES MAY 2024	02406575
00-4-0500	BUILDING/FACILITIES RENT	1,000.00	KEARNEY VISITOR'S BUREAU	EXPENSES MAY 2024	02406575
879-00 COUNTY VISITORS PROMOTION		89,301.00			
0900 VISITOR'S PROMOTION FUND		89,301.00			
879-00 COUNTY VISITORS PROMOTION					
00-2-2001	PROMOTIONAL ADVERTISING	36,000.00	KEARNEY VISITOR'S BUREAU	EXPENSES MAY 2024	02406576
00-2-6070	SPECIAL PROJECTS	53,300.00	KEARNEY VISITOR'S BUREAU	EXPENSES MAY 2024	02406576
879-00 COUNTY VISITORS PROMOTION		89,300.00			
0995 VISITORS PROMOTION IMPROVEMENT FUND		89,300.00			
604-00 DEEDS PRESERVATION & MODERNIZATION					
00-2-7000	PRESERVATION	257.03	MIPS INC.	CONVERSION DEEDS 240608020	02406577
604-00 DEEDS PRESERVATION & MODERNIZATION		257.03			
1150 DEEDS PRESERVATION & MODERNIZATION FUND		257.03			
614-00 INSURANCE					
00-1-0802	HEALTH INSURANCE CLAIMS	299,005.48	BCBS HEALTH CLAIM EXPENSE	HEALTH JUNE 2024 234 LIVES	02406578
00-1-0802	HEALTH INSURANCE CLAIMS	62,148.06	HM LIFE MELLON GLOBAL CAS	HEALTH JUNE 2024 234 LIVES	02406579
614-00 INSURANCE		361,153.54			

BUFFALO
BOARD PREAPPROVAL REPORT
HEALTH INSURANCE
FROM 06/25/2024 TO 06/27/2024

Account # 1099	Description	Account Amt	Vendor	Invoice Description	Claim #

	1275 HEALTH INSURANCE FUND	361,153.54			

802-00	VETERAN'S RELIEF				
00-2-8700	VETERANS AID COSTS	7,330.00	COUNTY VETERANS AID FUND	RELIEF VETERANS 3166 3167 3	02406580

	802-00 VETERAN'S RELIEF	7,330.00			

	1900 COUNTY VETERANS RELIEF FUND	7,330.00			

783-00	DRUG LAW ENFORCEMENT - CO				
00-2-1801	DUES, SUBSCRIPTIONS, REGISTRAT	33,105.00	MAGNET FORENSICS LLC	EXPENSE DRUG FORF. SIN06734	02406581
00-5-1100	LAW ENFORCEMENT EQUIPMENT PURC	5,425.00	TTI	EQUIP DRUG FORF. 27516	02406582

	783-00 DRUG LAW ENFORCEMENT - CO	38,530.00			

	2360 DRUG FORFEITURES FUND	38,530.00			

665-00	FEDERAL GRANTS - COUNTY SHERIFF				
00-5-0318	SAFETY EQUIPMENT	1,153.72	GALLS, LLC	EQUIP GRANT 028200283	02406583
00-5-0318	SAFETY EQUIPMENT	11,378.51	GOVCONNECTION INC	PROTECTION GRANTS 17005741	02406584

	665-00 FEDERAL GRANTS - COUNTY SHERIFF	12,532.23			

	2500 FEDERAL GRANTS FUND	12,532.23			

911-00	COVID AMERICAN RESCUE PLAN				
00-2-9900	MISCELLANEOUS	29,018.50	JONES AUTOMOTIVE	EQUIP BOARD 911	02406585
00-2-9900	MISCELLANEOUS	115,497.65	MOTOROLA SOLUTIONS, INC	EQUIP ARPA FUNDS 2024 0607	02406586

	911-00 COVID AMERICAN RESCUE PLAN	144,516.15			

BUFFALO
BOARD PREAPPROVAL REPORT
COVID AMERICAN RESCUE PLAN
FROM 06/25/2024 TO 06/27/2024

Account #	Description	Account Amt	Vendor	Invoice Description	Claim #

2580	COVID AMERICAN RESCUE PLAN FUND	144,516.15			

641-00	INHERITANCE TAX				
00-2-9900	7 MISC (COURT ORDERED REFUNDS)	208,029.37	ADAMS CONSTRUCTION	CONSTRUCTION BOARD APP 1 AP	02406587
00-2-9900	7 MISC (COURT ORDERED REFUNDS)	187.35	ELNORA M WEINRICH ESTATE	TAXES INHER. TAX 240044	02406588
00-2-9900	7 MISC (COURT ORDERED REFUNDS)	4,637.04	OAK CREEK ENGINEERING, LL	BOARD 24 110	02406589

641-00	INHERITANCE TAX	212,853.76			

2700	INHERITANCE TAX FUND	212,853.76			

697-00	911 SERVICES				
00-2-1200	MAINTENANCE	23,536.87	BUFFALO COUNTY TREASURER	SALARIES 911 WIRELESS JULY	02406590

697-00	911 SERVICES	23,536.87			

2913	911 WIRELESS SERVICE FUND FUND	23,536.87			

733-00	NOXIOUS WEED CONTROL				
00-3-0101	OFFICE SUPPLIES	18.98	U.S. BANK	EXPENSES BOARD 645717719	02406591

733-00	NOXIOUS WEED CONTROL	18.98			

5400	NOXIOUS WEED DISTRICT FUND	18.98			

697-00	911 EMERGENCY SERVICE				
00-2-0200	911 TELEPHONE SERVICE	1,764.44	CENTURYLINK	SVC 911 688560984 88167882	02406593
00-2-0200	911 TELEPHONE SERVICE	808.33	FRONTIER	PHONE SVC 911 1880122053091	02406594
00-2-0200	911 TELEPHONE SERVICE	1,380.00	GREAT PLAINS COMMUNICATIO	INTERNET 911 601301180	02406595
00-2-0200	911 TELEPHONE SERVICE	109.99	NEBRASKA CENTRAL TELEPHON	PHONE SVC 911 10934087 1093	02406596
00-2-0400	911 RADIO EQUIPMENT MAINT/REPA	21,447.09	CENTURYLINK	SVC 911 101456926	02406592
00-2-0400	911 RADIO EQUIPMENT MAINT/REPA	1,417.67	PLATTE VALLEY COMMUNICATI	REPAIRS 911 052924011	02406597

APS7040
6/18/24
14:49:18

BUFFALO
BOARD PREAPPROVAL REPORT
911 EMERGENCY SERVICE
FROM 06/25/2024 TO 06/27/2024

Account # 1099 Description Account Amt Vendor Invoice Description Claim #

697-00 911 EMERGENCY SERVICE *****
26,927.52

5907 911 EMERGENCY SERVICE FUND *****
26,927.52

GRAND *****
5,395,082.47

_____	_____
_____	_____
_____	_____
_____	_____

ESU 10 – Buffalo County
Agreement for Maintenance and Hosting Website
July 1, 2024 – June 30, 2025

Primary POC

Paul Farrell <pfarrell@buffalocounty.ne.gov>

Name & E-mail Address

308-236-1236

Phone Number

Secondary POC

Lynn Martin <lmartin@buffalocounty.ne.gov>

Name & E-mail Address

(308) 236-1224

Phone Number

Approved By:

Educational Service Unit 10

Melissa Wheelock, Administrator

Buffalo County Board of Commissioners

(board member, title, signature, date)



PETITION TO VACATE PUBLIC ROAD OR PORTION OF SUCH ROAD

TO:

Heather A. Christensen, Buffalo County Clerk
c/o Buffalo County Courthouse

The undersigned petitioners, each being an elector residing with ten (10) miles of the street or portion to be vacated or abandoned, do petition Buffalo County, Nebraska, in accordance with Neb.Rev.Stat. Sec. 39-1723 to vacate or abandon the following-described public road/street:

(Legal description)

Reason(s) for vacation or abandonment are:

1. This street although previously dedicated has not been available to the public or used for public travel since platted in 1972.
2. This street is simply an "open" street on the records of Buffalo County and it serves no general public purpose.
3. All accesses to lands along this street are provided by other opened public roads.

Petitioners request that the Buffalo County Board:

1. Refer this request to the Buffalo County Highway Road Superintendent.
2. Refer this request to the appropriate municipal body, if applicable.

Thereafter, after receiving response(s) or elapse of time for response(s), that this matter proceed to vacation or abandonment of this road as provided by law.

(Describe reason)

Signatures, printed names, and address of each of the petitioners are as follows:

PETITION TO VACATE PUBLIC ROAD OR PORTION OF SUCH ROAD

TO:

Heather A. Christensen, Buffalo County Clerk
c/o Buffalo County Courthouse

The undersigned petitioners, each being an elector residing with ten (10) miles of the street or portion to be vacated or abandoned, do petition Buffalo County, Nebraska, in accordance with Neb.Rev.Stat. Sec. 39-1723 to vacate or abandon the following-described public road/street:

(Legal description)

OVERGREEN RD BETWEEN 220TH RD AND 235TH RD
BETWEEN ~~R~~ SECTION 11-17 AND SECTION 30 11-16

Reason(s) for vacation or abandonment are:

1. This street although previously dedicated has not been available to the public or used for public travel since platted in 1972.
2. This street is simply an "open" street on the records of Buffalo County and it serves no general public purpose.
3. All accesses to lands along this street are provided by other opened public roads.

Petitioners request that the Buffalo County Board:

1. Refer this request to the Buffalo County Highway Road Superintendent.
2. Refer this request to the appropriate municipal body, if applicable.

Thereafter, after receiving response(s) or elapse of time for response(s), that this matter proceed to vacation or abandonment of this road as provided by law.

(Describe reason)

Signatures, printed names, and address of each of the petitioners are as follows:

Evergreen Road running North and South
 between 220th Road and 235th Road abutting
 the East Half of the East Half of Section 25,
 Township 11 North, Range 17 West and the
 West Half of the West Half of Section 30,
 Township 11 North, Range 16 West of the 6th
 P.M., all in
SCOTT
 T11N - R17W

Buffalo County, Nebraska

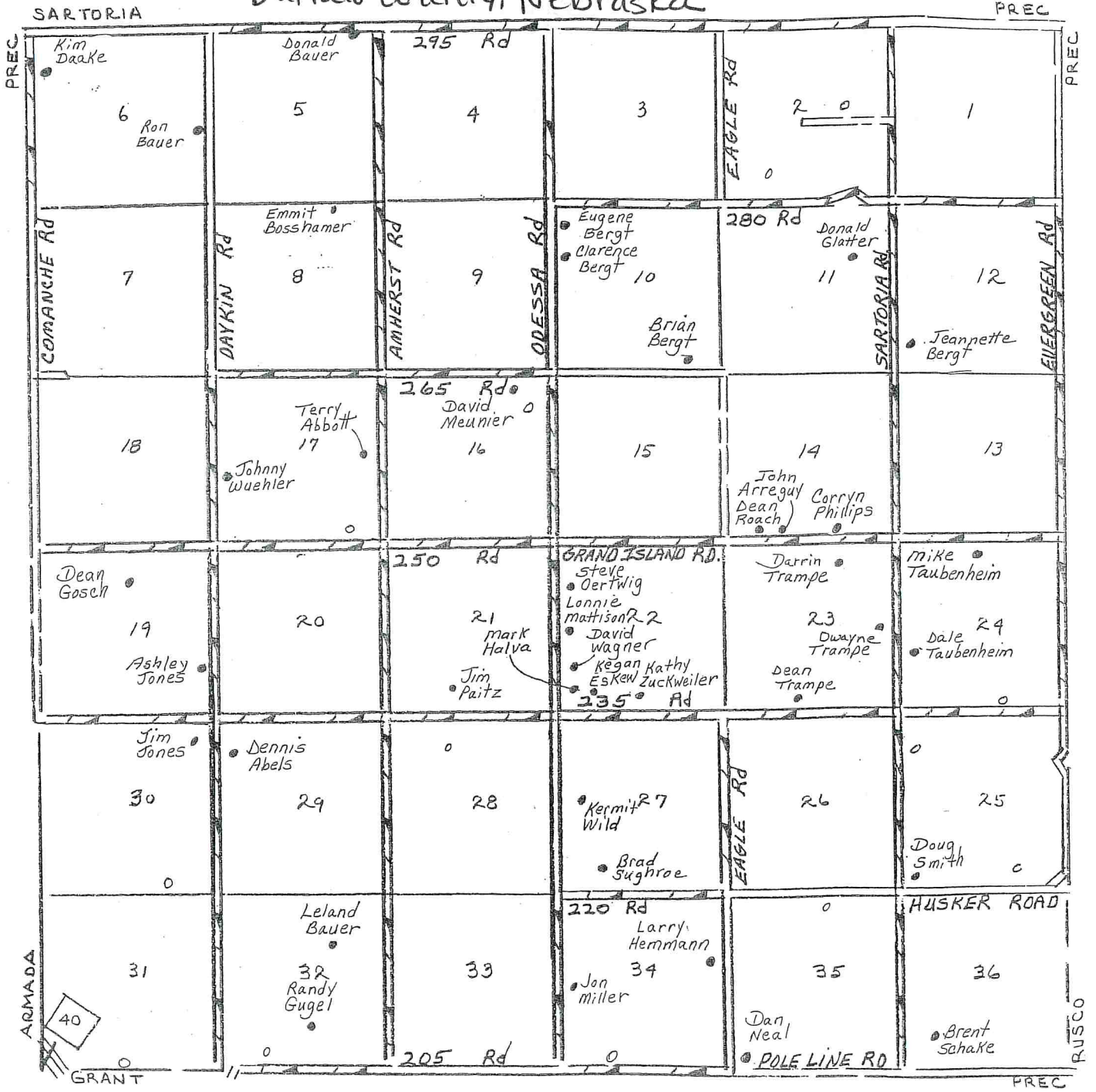

✓ Name: Dale Taubenheim Address: 23685 Sartoria Rd
Printed Name: Dale Taubenheim Amherst, NE 68812

✓ Name: Jeannette Taubenheim Address: 23685 Sartoria Rd
Printed Name: Jeannette Taubenheim Amherst, NE 68812

✓ Name: M Address: 19035 Grand Island Rd
Printed Name: Michael Taubenheim Amherst, NE 68812

✓ Name: Justin Taubenheim Address: 220N Sycamore St. Amherst, NE
Printed Name: JTM 68812

✓ Name: KR Address: 21280 Pole Line Rd Riverdale NE
Printed Name: Kris Rasmussen 68870

✓ Name: J Address: 220 N Sycamore St Amherst NE
Printed Name: Janelle Taubenheim 68812

✓ Name: David Ourada Address: 204 N Sycamore St Amherst, NE
Printed Name: David Ourada 68812

✓ Name: Angie Ourada Address: 204 N Sycamore Amherst, NE 68812
Printed Name: Angie Ourada

✓ Name: Scott Trampe Address: 13300 Evergreen RD
Printed Name: Scott Trampe Riverdale NE 68870

✓ Name: Julie Trampe Address: 13300 Evergreen R
Printed Name: Julie Trampe Riverdale 68870

✓ Name: Haar Cox Address: 21343 Sartoria Rd Amherst NE
Printed Name: Harrison Trampe 68812

✓ Name: Kelsi Trampe Address: 21343 Sartoria Rd Amherst NE
Printed Name: Kelsi Trampe 68812

✓ Name: Renee Taubenheim Address: 19035 Grand Island Rd Amherst
Printed Name: Renee Taubenheim NE 68812

✓ Name: Dean Trampe Address: 23920 Sartoria RD Amherst NE
Printed Name: Dean Trampe 68812

✓ Name: Melissa Trampe Address: 23960 Sartoria Rd Amherst NE
Printed Name: Melissa Trampe 68812

✓ Name: Seth Taubenheim Address: 19035 Grand Island Rd Amherst NE
Printed Name: Seth Taubenheim 68812

✓ Name: Leslie Vavra Address: 17270 145 RD Amherst NE 68812
Printed Name: Leslie Vavra

✓ Name: John Vavra Address: 17985 145th Rd Amherst NE 68812
Printed Name: John Vavra

Name: _____ Address: _____

Printed Name: _____

Name: _____ Address: _____

Printed Name: _____

✓ Name: Logan Dibern Address: 19830 220th Rd Amherst, NE 68812

Printed Name: Logan Dibern

✓ Name: Mynhyla Dibern Address: 19830 220th Rd Amherst, NE 68812

Printed Name: Mynhyla Dibern

✓ Name: Billy Dibern Address: 18310 Dove Hill Rd Riverdale NE, 68870

Printed Name: Billy Dibern

✓ Name: Karen Dibern Address: 18310 Dove Hill Rd Riverdale, Ne 68870

Printed Name: Karen Dibern

✓ Name: Colin Dibern Address: 23655 265th Rd Pleasanton Ne 68866

Printed Name: Colin Dibern

✓ Name: Devin Dibern Address: 18550 Amherst Rd Amherst, NE 68812

Printed Name: Devin Dibern

✓ Name: Kinzy Dibern Address: 18550 Amherst Rd Amherst, NE 68812

Printed Name: Kinzy Dibern

Name: _____ Address: _____

Printed Name: _____

Name: _____ Address: _____

Printed Name: _____

Name: _____ Address: _____

Printed Name: _____

File with Your
County Treasurer

Application for Exemption from Motor Vehicle Taxes by Qualifying Nonprofit Organizations

FORM
457

• Read instructions on reverse side.

Name of Organization GRACE FELLOWSHIP INC		Tax Year 2024	Value of Motor Vehicles
Name of Owner of Property		County Name BUFFALO	State Where Incorporated NEBRASKA
Street or Other Mailing Address 4305 19TH AVE		Contact Name KATIE ADAM	Phone Number 308-236-7257
City KEARNEY	State NE	Zip Code 68845	Email Address KATIE.ADAM@KEARNEYGRACE.COM

Type of Ownership
 Agricultural and Horticultural Society
 Educational Organization
 Religious Organization
 Charitable Organization
 Cemetery Organization

Name	Title of Officers, Directors, or Partners	Address, City, State, Zip Code
MITCH IVEY	PRESIDENT	2415 67TH ST PL KEARNEY, NE 68845
BRIAN BONTZ	VICE PRESIDENT	1506 8TH AVE, KEARNEY, NE 68845
MIKE GRADY	TREASURER	2404 W 44TH ST PL, KEARNEY, NE 68845

Description of the Motor Vehicles
 • Attach an additional sheet, if necessary.

Motor Vehicle Make	Model Year	Body Type	Vehicle ID Number	Registration Date or Date of Acquisition, if Newly Purchased
CHEVY C2500	2003	PICKUP	1GCHC24U03E344390	07/2024
FORD F250	2004	PICKUP	3FTNF20L24MA06721	07/2024
HHCT	2009	ENCLOSED TRAILER	4J6TC26289B113897	07/2024
HHCT	2015	ENCLOSED TRAILER	533TC1628FC250867	07/2024
UTILITY TRAILER	2000	FLATBED TRAILER	4ET720A23Y1004034	07/2024

Motor Vehicle described above is used in the following exempt category (please mark the applicable boxes):
 Agricultural and Horticultural Society
 Educational
 Religious
 Charitable
 Cemetery

Give a detailed description of the use of the motor vehicle:
MINISTRY NEEDS, MAINTENANCE, MISSIONS TRIPS

Are the motor vehicles used exclusively as indicated? (see instructions) *cont.*
 YES NO
 If No, give percentage of exempt use:
 _____ %

Under penalties of law, I declare that I have examined this exemption application and, to the best of my knowledge and belief, it is correct and complete. I also declare that I am duly authorized to sign this exemption application.

sign here *Katie Adam* _____ **ADMINISTRATOR** _____ **06/03/2024**
 Authorized Signature Title Date

For County Treasurer Recommendation

Approval Denial Comments: _____

Bunda R. Rehrich _____ **6-10-24**
 Signature of County Treasurer Date

For County Board of Equalization Use Only

Approved Denied If the County Board's determination is different from the County Treasurer's recommendation, an explanation is required.

I declare that to the best of my knowledge and belief, the determination made by the County Board of Equalization is correct pursuant to the laws of the State of Nebraska.

Signature of County Board Member _____ Date _____

Please retain a copy for your records.

File with Your
County Treasurer

Application for Exemption from Motor Vehicle Taxes by Qualifying Nonprofit Organizations

FORM
457

• Read instructions on reverse side.

Name of Organization GRACE FELLOWSHIP INC		Tax Year 2024	Value of Motor Vehicles
Name of Owner of Property		County Name BUFFALO	State Where Incorporated NEBRASKA
Street or Other Mailing Address 4305 19TH AVE		Contact Name KATIE ADAM	Phone Number 308-236-7257
City KEARNEY	State NE	Zip Code 68845	Email Address KATIE.ADAM@KEARNEYGRACE.COM

Type of Ownership
 Agricultural and Horticultural Society
 Educational Organization
 Religious Organization
 Charitable Organization
 Cemetery Organization

Name	Title of Officers, Directors, or Partners	Address, City, State, Zip Code
MITCH IVEY	PRESIDENT	2415 67TH ST PL KEARNEY, NE 68845
BRIAN BONTZ	VICE PRESIDENT	1506 8TH AVE, KEARNEY, NE 68845
MIKE GRADY	TREASURER	2404 W 44TH ST PL, KEARNEY, NE 68845

Description of the Motor Vehicles

• Attach an additional sheet, if necessary.

Motor Vehicle Make	Model Year	Body Type	Vehicle ID Number	Registration Date or Date of Acquisition, if Newly Purchased
FORD ECONOLINE	2004	COMMERCIAL CUTAWAY	1FCXE45X04HB27075	07/2024
FORD ECONOLINE	2008	COMMERCIAL CUTAWAY	1FD4E45S68DB17831	07/2024

Motor Vehicle described above is used in the following exempt category (please mark the applicable boxes):

Agricultural and Horticultural Society
 Educational
 Religious
 Charitable
 Cemetery

Are the motor vehicles used exclusively as indicated? (see instructions)

YES NO

Give a detailed description of the use of the motor vehicle:

MINISTRY NEEDS, MAINTENANCE, MISSIONS TRIPS

If No, give percentage of exempt use:

_____ %

Under penalties of law, I declare that I have examined this exemption application and, to the best of my knowledge and belief, it is correct and complete. I also declare that I am duly authorized to sign this exemption application.

sign here

Katie Adam
Authorized Signature

ADMINISTRATOR

06/03/2024

Title

Date

For County Treasurer Recommendation

Approval
 Denial

Comments: _____

Brenda R Rohrich
Signature of County Treasurer

6-10-24
Date

For County Board of Equalization Use Only

Approved
 Denied

If the County Board's determination is different from the County Treasurer's recommendation, an explanation is required.

I declare that to the best of my knowledge and belief, the determination made by the County Board of Equalization is correct pursuant to the laws of the State of Nebraska.

Signature of County Board Member

Date

Please retain a copy for your records.



Application for Exemption from Motor Vehicle Taxes by Qualifying Nonprofit Organizations

• To be filed with your county treasurer.
• Read instructions on reverse side.

FORM
457

Applicant's Name South Central Behavioral Services, Inc.			Type of Ownership <input checked="" type="checkbox"/> Nonprofit Corporation <input type="checkbox"/> Other (specify): _____
Street or Other Mailing Address 3810 Central Ave, PO Box 1715		County Buffalo	
City Kearney	State NE	Zip Code 68848	State Where Incorporated NE

IDENTIFY OFFICERS, DIRECTORS, OR PARTNERS OF THE NONPROFIT ORGANIZATION

Title	Name, Address, City, State, Zip Code
President	Jean Issler, 1616 12th Ave Unit #9, Holdrege, NE. 68949
Vice President	Nancy Morse, 10514 735 Road, Loomis, NE. 68958
Secretary/CEO	Robert Shueey, 616 West 5th, Hastings, NE 68901
Treasurer	RuAnn Root, 603 West 3rd, Juniata, NE. 68955

DESCRIPTION OF THE MOTOR VEHICLES • Attach an additional sheet, if necessary.

Motor Vehicle Make	Model Year	Body Type	Vehicle ID Number	Registration Date or Date of Acquisition, if Newly Purchased
See attached list				

Exempt Uses of Motor Vehicle:

- Agricultural/Horticultural Educational Religious Charitable Cemetery

Give detailed description of use, including an explanation if multiple use classifications exist:

Travel between clinics and service sites. Services provided include Mental Health, Substance Abuse, Specialized Children's Services, Rehabilitation and Assertive Community Treatment for adults with severe and persistent mental illness.

Are the motor vehicles used exclusively as indicated?

- YES NO

If No, give percentage of exempt use:

_____ %

Under penalties of law, I declare that I have examined this application and that it is, to the best of my knowledge and belief, true, complete, and correct. I also declare that I am duly authorized to sign this exemption application, and that the organization owning the above-listed property does not discriminate in membership or employment based on race, color, or national origin.

sign here

[Signature]
Authorized Signature

Administrative Assistant

6/3/2024

Title

Date

FOR COUNTY TREASURER RECOMMENDATION

APPROVAL

COMMENTS: _____

DISAPPROVAL

[Signature]
Signature of County Treasurer

6-10-24
Date

FOR COUNTY BOARD OF EQUALIZATION USE ONLY

APPROVAL

COMMENTS: _____

DISAPPROVAL

Authorized Signature

Date

2T3RFREXFW363229	2015	TOYOTA RAV	BLUE	7/31/2024
JTEES42AX820427152	2008	TOYOTA HIGHLANDER	WHITE	7/31/2024
JTNBE46K473061978	2007	TOYOTA CAMRY	Lt. GREEN	7/31/2024
4T1BE46K89U289253	2009	TOYOTA CAMRY	GRAY	7/31/2024
1GAHG35U351261645	2005	CHEVY EXPRESS VAN	WHITE	7/31/2024
JTMRFREXFD133039	2015	TOYOTA RAV	SILVER	7/31/2024
2C7WDGBG4HR618329	2017	BRAUN WAGON	WHITE	7/31/2024
2T3BF4DV7BW149251	2011	TOYOTA RAV4	SILVER	7/31/2024
4T4BE46K47R007614	2007	TOYOTA CAMRY	SAND	7/31/2024
2T3G1RFV2RC436605	2024	TOYOTA RAV4	GRAY	7/31/2024
5FNRL6H52PB055059	2023	HONDA ODYSSEY	BLUE	7/31/2024

File with Your County Assessor on or Before December 31

Exemption Application for Tax Exemption on Real and Personal Property by Qualifying Organizations

Read instructions on reverse side.

RECEIVED
BUFFALO COUNTY ASSESSOR'S OFFICE
FORM 451
DATE 6-5-2024

Failure to properly complete or timely file this application will result in a denial of the exemption.

Name of Organization Heather Santiago LLC	County Name Buffalo	Tax Year 2024
Name of Business if Different than Organization Kearneys Village	State Where Incorporated Nebraska	
Name of Owner of Property Heather Santiago LLC	Value of Real Property \$1.2 million	Value of Personal Property \$1.2 million
Street or Other Mailing Address of Applicant 709 2nd Avenue	Contact Name Heather Santiago	Phone Number 308-233-1553
City Kearney NE	State NE	Zip Code 68847
Email Address heathersantiago-84@yahoo.com		

Type of Organization (Please attach documentation of organization's formation and purpose)

- Agricultural and Horticultural Society
 Educational Organization
 Religious Organization
 Charitable Organization
 Cemetery Organization

Name	Title of Officers, Directors, or Partners	Phone Number	Email Contacts

Legal description of real property and general description of all depreciable tangible personal property, except licensed motor vehicles:

For more information on permissive exemptions, please scan the QR code.



Property described above is used in the following exempt category (please mark the applicable boxes):

- Agricultural and Horticultural Society
 Educational
 Religious
 Charitable
 Cemetery

Give a detailed description of the primary use of the property and all other uses of the property: Please attach ALL documents that would support the property for possible exemption. The burden of proof lies with the organization applying for exemption. Please attach additional pages if needed.

Transitional And Sober Living w/ programming.

All organizations, except for an Agricultural and Horticultural Society, must complete the following questions.

- Is all of the property used exclusively as described above? YES NO
 Is the property used for financial gain or profit to either the owner, the owner or organization making exclusive use of the property, or private individuals? YES NO
 Is a portion of the property used for the sale of alcoholic beverages? YES NO
 If Yes, state the number of hours per week _____
 Is the property owned or used by an organization which discriminates in membership or employment based on race, color, or national origin? YES NO

Under penalties of law, I declare that I have examined this exemption application and, to the best of my knowledge and belief, it is correct and complete. I also declare that I am duly authorized to sign this exemption application.

sign here

Heather Santiago
Authorized Signature

Owner
Title

5/6/2024
Date

Retain a copy for your records.

For County Assessor's Recommendation

Approval

Approval of a Portion

Denied

COMMENTS: _____

[Signature]
Signature of County Assessor

6-5-2024
Date

For County Board of Equalization Use Only

Approved

Approval of a Portion

Denied

If the County Board's determination is different from the County Assessor's recommendation, an explanation is required.

I declare that to the best of my knowledge and belief, the determination made by the County Board of Equalization is correct pursuant to the laws of the State of Nebraska.

Signature of County Board Member

Date

County Clerk: A legible copy of this form showing the final decision of the County Board of Equalization must be delivered electronically to the Nebraska Department of Revenue within seven days after the Board's decision.



KEARNEY'S VILLAGE

5/8/2024

Dear County Board of Commissioners,

On April 15th, 2024 Heather Santiago LLC purchased the property located at 709 2nd Avenue Kearney Nebraska 68847. I am filing a property tax exemption for this property however I am late doing so. The reason that I am late is because the exemption must be filed by January 1st, however the property was not purchased until after that date. I am asking for your forgiveness for this. Please allow me to proceed in filing this exemption.

I truly appreciate your time on this matter.

Thank You,

A handwritten signature in black ink that reads "Heather Santiago". The signature is written in a cursive, flowing style.

Heather Santiago

Kearney's Village Transitional and Sober Living

824 East 25th Street

2523 Avenue A

2525 Avenue A

317 West 28th Street

709 2nd Avenue

308-234-2408 Office

308-233-1553 Cell

File with Your County Assessor on or Before December 31

Exemption Application

for Tax Exemption on Real and Personal Property by Qualifying Organizations

Read instructions on reverse side.

FORM

451

RECEIVED

Failure to properly complete or timely file this application will result in a denial of the exemption.

Name of Organization St. Teresa of Calcutta Newman Center		County Name Buffalo	Tax Year 2024
Name of Business if Different than Organization		State Where Incorporated Nebraska	DATE <u>6/10/2024</u>
Name of Owner of Property	Value of Real Property \$195,000	Value of Personal Property \$40,000	Parcel ID Number 0604538000
Street or Other Mailing Address of Applicant 811 W 27th St.		Contact Name Alfred Schwalbe	Phone Number 308-234-1539
City Kearney	State NE	Zip Code 68845	Email Address info@lopercatholic.org
Type of Ownership <input type="checkbox"/> Agricultural and Horticultural Society <input type="checkbox"/> Educational Organization <input checked="" type="checkbox"/> Religious Organization <input type="checkbox"/> Charitable Organization <input type="checkbox"/> Cemetery Organization			

Name	Title of Officers, Directors, or Partners	Address, City, State, Zip Code
Joseph G Hanefeldt	President	3708 Old Fair Rd, Grand Island, NE 68803
Donald Buhrman	Vice President	2511 Del Monte Ave, Grand Island, NE 68803
Neal Hock	Secretary	805 W 27th St, Kearney, NE 68845

Legal description of real property and general description of all depreciable tangible personal property, except licensed motor vehicles:

P & H ADD KY LT 7 BLK 36

situs: 805 W 27th St, Kearney, NE 68845

Property described above is used in the following exempt category (please mark the applicable boxes):

Agricultural and Horticultural Society Educational Religious Charitable Cemetery

Give a detailed description of the primary use of the property and any other uses of the property:

This property is used as the priest residence aka rectory. The space is used as a personal dwelling for clergy and also for activities associated with the ministry such as grill outs, bonfires, and fundraising events. This property is used to meet the spiritual needs of colle students in Kearney, NE.

All organizations, except for an Agricultural and Horticultural Society, must complete the following questions.

- Is all of the property used exclusively as described above? YES NO
- Is the property used for financial gain or profit to either the owner, the owner or organization making exclusive use of the property, or private individuals? YES NO
- Is a portion of the property used for the sale of alcoholic beverages? YES NO
If Yes, state the number of hours per week _____
- Is the property owned or used by an organization which discriminates in membership or employment based on race, color, or national origin? . . . YES NO

Under penalties of law, I declare that I have examined this exemption application and, to the best of my knowledge and belief, it is correct and complete. I also declare that I am duly authorized to sign this exemption application.

sign here

Rev Neal Hock
Authorized Signature

Secretary
Title

06/07/2024
Date

Retain a copy for your records.

For County Assessor's Recommendation

- Approval
- Approval of a Portion
- Denied

COMMENTS: _____

[Signature]
Signature of County Assessor

6/10/2024
Date

For County Board of Equalization Use Only

- Approved
- Approval of a Portion
- Denied

If the County Board's determination is different from the County Assessor's recommendation, an explanation is required.

I declare that to the best of my knowledge and belief, the determination made by the County Board of Equalization is correct pursuant to the laws of the State of Nebraska.

Signature of County Board Member

Date

County Clerk: A legible copy of this form showing the final decision of the County Board of Equalization must be delivered electronically to the Nebraska Department of Revenue within seven days after the Board's decision.

2024 THREE YEAR ASSESSMENT PLAN

BUFFALO COUNTY ASSESSMENT YEARS 2025, 2026, & 2027



Prepared by:

Roy Meusch, Buffalo County Assessor

Phone: 308-236-1205

Email: rmeusch@buffalocounty.ne.gov

Table of Contents

- Increase by Parcel, Valuation & Growth.....3
- Forecast Table of 6-year reviews.....4
 - A) Review Activities
- Current Resources.....6
 - A) General Office Info
 - B) Staff
 - C) Budget
- Assessor’s Duties and Responsibilities.....7
 - A) Record Maintenance, Mapping and Ownership Changes
 - B) Assessor Administrative Reports
 - C) Personal Property
 - D) Permissive Exemptions
 - E) Taxable Government owned property
 - B) Homestead Exemption
 - F) Centrally Assessed Properties
 - G) Tax Increment Financing
 - H) Taxing Districts and Tax Rates
 - I) Tax List Corrections
 - J) County Board of Equalization: Protest Process
 - K) Tax Equalization and Review Commission
- Conclusion.....11
- Statutory Requirements.....3

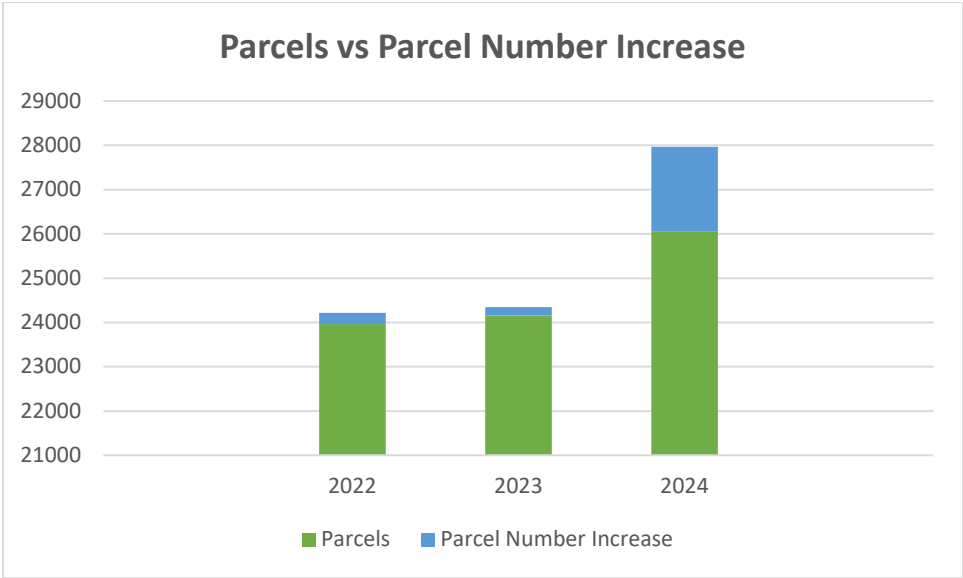
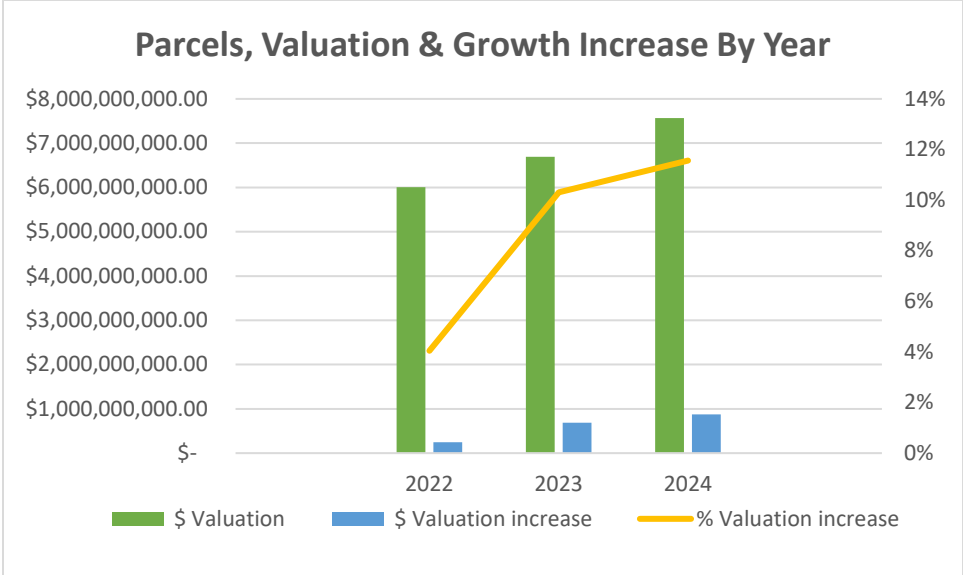

SOURCE: BUFFALO COUNTY ABSTRACT OF ASSESSMENT FOR REAL PROPERTY, FORM 45 AND/OR YEARLY R & O BY PROPERTY ASSESSMENT DIVISION, NE DEPT OF REVENUE

STAFF

Field Reviewers

For 2024 we have 4 Full Time Equivalent Field reviewers available to accomplish review requirements which include protest reviews, pick-up, permit, preliminary value, and sales review work. They go on appointments and help property owners with all queries and explanations. The field staff are currently all using 'Surface Pros' to do their field work. This greatly enhances the amount of work that can be done and cuts down on the amount of time spent in the office. The Surface Pros also take pictures and automatically update the property records. They allow reviewer the opportunity to show property owners the information in their property record while on site. All field reviewers are prepared to assist with other areas of responsibility when necessary. They can wait on the counter and help with questions and forms.

Activities Performed During Preliminary Values, Neighborhood Review, Sales Review, Protest Review and Pickup Work

These reviews include:

- Re-measuring house, sheds and outbuildings as necessary.
- Evaluating Quality / Condition and noting if remodeling has taken place.
- Noting kitchen and bathrooms Q / C and pictures taken.
- Evaluating the siding including calculation of percentage of brick veneer
- Obtaining the number of plumbing fixtures
- Obtaining the amount of basement finish
- Establishing an attached and/or detached garage and its size, condition and interior finish
- Re-measuring and recording all miscellaneous improvements – porches, decks, covered or uncovered entries, garage finish, walkout basement, garden level basement, egress windows and measuring concrete patios if changed
- Taking pictures front / back of main building and outbuildings
- Updating the parcel record with any changes observed and noted.
- Checking drawings to 1" = 20' Scale
- Entering pictures, notes, and adjustments in the CAMA system.

Office Staff for 2024

There are 3.0 office staff employees. They assist at the counter, answer phone calls, answer questions, wait on the public and do day-to-day duties. All of them can assist with Homestead and Personal Property. Two people assist with sales entry, Permissive Exemption properties and special projects. Two of the clerical staff do most of the reports and information for the state.

The deputy does special inquiries, sending sales verifications, entering sales and trouble shooting. She also handles Computer information, MIPS updates and checks input for accuracy. If needed, the deputy aids with review work and assists in every aspect of anything that needs to be done in the office.

Assessor's Staff, Office Duties and Responsibilities

1. **Record Maintenance, Mapping Updates & Ownership Changes**
2. **Assessor Administrative Reports Annually prepare & file required by statute/regulation**
 - Abstracts (Real and Personal Property)
 - Assessor Survey
 - Sale information to PAD roster & annual Assessed Value Update with Certification of Value to Political Subdivisions
 - School District Taxable Value Report
 - Homestead Exemption Tax Loss Report (in conjunction with Treasurer)
 - Certificate of Taxes Levied Report
 - Report of current values for properties owned by Board of Educational Lands & Funds
 - Report of all Exempt Property and Taxable Government Owned Property
 - Annual Plan of Assessment Report
3. **Personal Property**

Administer annual filing of Buffalo County schedules, prepare subsequent notices for incomplete filings or failure to file and penalties applied, as required.
4. **Permissive Exemptions**

Administer annual filings of applications for a new (Form 451) or continued exempt use (Form 451a), review and make recommendations to B.O.E.
5. **Taxable Government Owned Property**

Annual review of government owned property not used for public purpose, send notices of intent to tax, etc.
6. **Homestead Exemptions**

Administer Buffalo County annual filings of applications, approval/denial process, taxpayer notifications, and taxpayer assistance.
7. **Centrally Assessed**

Review of valuations as certified by PAD for railroads and public service entities, establish assessment records and tax billing for tax list.
8. **Tax Increment Financing**

Management of record/valuation information for properties in community development projects for proper reporting on administrative reports and allocation of ad valorem tax.

9. Tax Districts and Tax Rates

Management of school district and other tax entity boundary changes
Necessary for correct assessment and tax information; input/review of levy rates used for tax billing process.

10. Tax Lists/Tax List corrections

Prepare and certify tax lists to county treasurer for real property, personal property, and centrally assessed property, & prepare correction documents for B.O.E. approval and for county treasurer.

11. County Board of Equalization

Prepare information for the B.O.E., attend hearings, if applicable for the county, defend values (LOV) and sales file, and/or implement orders of the T.E.R.C.

12. Tax Equalization and Review Commission Appeals

Prepare Information for the B.O.E. to defend their BASIS for decision, defend assessor determined Level of Value (LOV) and sales file, and/or "Show Cause" to the T.E.R.C. for LOV or methodology as the need specifies.

13. T.E.R.C. Statewide Equalization

Attend hearings, if applicable to county, defend values, and/or implement orders of the T.E.R.C. Notify PAD of execution orders and when implemented.

14. Education

Attend meetings, workshops and educational classes to obtain required hours of continuing education to maintain the Assessor Certification.
All Staff attends training provided by the State that is pertinent to their specific duties.

15. Assessor's Property Assessment & Taxation Calendar

Complete Assessor's Office calendar tasks in a timely manner.

BUDGET

The Budget has not been set at the time of this writing.

Conclusion

There are 26,000+ parcels in Buffalo County with modest increases in the number of parcels in the last 5 years. Those properties scheduled for review in 2024 and protested properties will be reviewed this summer as well as neighborhoods which have signs of inequality within them.

Rural residential properties in the same township and range areas will be reviewed as well as acreages around Kearney. Multiple neighborhoods in Kearney are being reviewed. Land values for residential neighborhoods, acreages and rural home-sites will be reviewed. Residential depreciation and effective age will be closely monitored in Kearney, small towns, acreages and rural home sites.

We are realigning the review process in Kearney so the six areas of town are reviewed one each in the six-year process rather than in bits and pieces. This would make the sales reviews and studies much more understandable. We are combining some neighborhoods in Kearney as there are neighborhoods with very few parcels. This will result in some neighborhoods being review a little sooner than the 6 years, in order to make the numbers more even throughout the 6 years.

Special Value and Agricultural properties, as well as acreages, are reviewed and updated in the new review configuration.

We are visiting with many folks, especially those that file protests every year. We also are working on making sure the costing information on all records is as complete and correct as possible.

Commercial properties and sales continue to be reviewed. Many commercial neighborhoods have been realigned, values will be examined along with occupancy codes versus price/ sq. ft. We have requested and are receiving income data from multiple commercial owners and will continue to work on moving to income and expense information for 2025 for the majority of commercial properties.

We will do preliminary values again in 2025 which will allow property owners to come in and visit with us before the actual 2025 values are set. This was a successful use of time in past years.

Respectfully submitted, July 15, 2024

Roy Meusch
Buffalo County Assessor

Statutory Requirements

Pursuant to [Neb. Revised Statute, 77-1311.02](#),

The county assessor shall, on or before June 15 each year, prepare a plan of assessment which shall describe the assessment actions the county assessor plans to make for the next assessment year and two years thereafter. The plan shall indicate the classes or subclasses of real property that the county assessor plans to examine during the years contained in the plan of assessment. The plan shall describe all the assessment actions necessary to achieve the levels of value and quality of assessment practices required by law and the resources necessary to complete those actions. The plan shall be presented to the county board of equalization on or before July 31 each year. The county assessor may amend the plan, if necessary, after the budget is approved by the county board. A copy of the plan and any amendments thereto shall be mailed to the Department of Revenue on or before October 31 each year.

Pursuant to [Neb. Revised Statute, 77-1311.03](#)

On or before March 19 of each year, each county assessor shall conduct a systematic inspection and review by class or subclass of a portion of the taxable real property parcels in the county for the purpose of achieving uniform and proportionate valuations and assuring that the real property record data accurately reflects the property. The county assessor shall adjust the value of all taxable real property parcels by class or subclass in the county so that the value of all real property is uniform and proportionate. The county assessor shall determine the portion to be inspected and reviewed each year to assure that all parcels of real property in the county have been inspected and reviewed no less frequently than every six years.

Pursuant to [Neb. Revised Statute, 77-112](#)

All property in the State of Nebraska is subject to property tax unless expressly exempt by Nebraska Constitution, Article VIII, or permitted by the constitution and enabling legislation adopted by the legislature. The uniform standard for the assessed value of real property for tax purposes is actual value, which is defined by law as "the market value of real property in the ordinary course of trade.

Acceptable Range of Values

Pursuant to [Neb. Revised Statute 77-5023](#)

(2) An acceptable range is the percentage of variation from a standard for valuation as measured by an established indicator of central tendency of assessment. Acceptable ranges are: (a) For agricultural land and horticultural land as defined in section [77-1359](#), sixty-nine to seventy-five percent of actual value; (b) for lands receiving special valuation, sixty-nine to seventy-five percent of special valuation as defined in section [77-1343](#); and (c) for all other real property, ninety-two to one hundred percent of actual value.

(3) Any increase or decrease shall cause the level of value determined by the commission to be at the midpoint of the applicable acceptable range.

Acceptable ranges are:

- (a) For **agricultural land and horticultural land 69% to 75%** of actual value.
- (b) For lands receiving **special valuation 69% to 75%** of actual value.
- (c) For **all other real property, 92% to 100%** of actual value. e.g., Residential and Commercial/Industrial